

Parts List

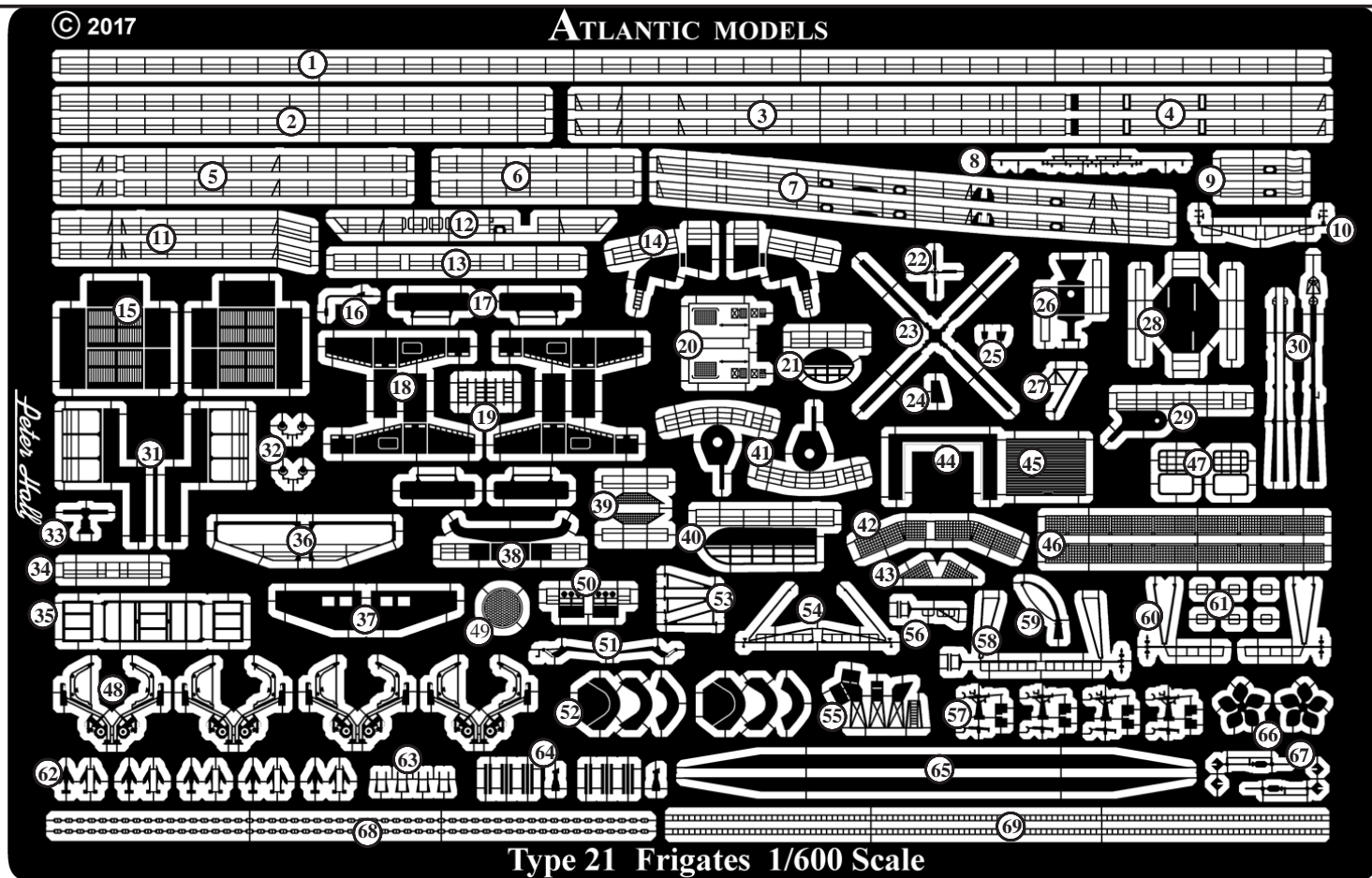

- | | | |
|-------------------------------------|--|--------------------------------------|
| 1. Railing (Stock Length) | 24. Lynx Helicopter Tail Plane | 47. Funnel Main Exhaust Grills |
| 2. Railings (Main Deck Forward) | 25. Lynx Helicopter Blade Aerials | 48. Boat Davits |
| 3. Railings (Main Deck Amidships) | 26. 992 Radar Platform Extension | 49. Flight Deck Harpoon Grid |
| 4. Railings (Main Deck Aft) | 27. Forward RAS Gantry | 50. Flight Deck Floodlight Platforms |
| 5. Railings (Superstructure Deck) | 28. Fore Mast Top Platform | 51. Towed Decoy Crane |
| 6. Railings Intake Box Catwalk | 29. Fore Mast Nav Radar Platform | 52. Chaff Launcher Enclosures |
| 7. Railings (Focsls) | 30. Main Mast Antenna Pole | 53. Torpedo Loading Gantries |
| 8. Approach Light Bar | 31. Intake Box Catwalks & Supports | 54. Yardarms (Fore Mast Aft Upper) |
| 9. Railings (Flight Deck Fwd) | 32. Signal Lamps | 55. Wire Antenna Collector Unit |
| 10. Yardarms (Foremast Fwd Quarter) | 33. IFF Antenna | 56. Yardarm (Fore Mast Front) |
| 11. Railings (Hangar Roof) | 34. Railing (Hangar Roof Aft) | 57. 20mm Oerlikon Mountings |
| 12. Railings (Stern) | 35. Small Boat Stowage Rack | 58. Yardarms (Fore Mast Side) |
| 13. Railings (Focsls Step) | 36. Aft Hull Step Deck Support (Early) | 59. Small Boat Davit |
| 14. Exocet Launcher Platforms | 37. Aft Hull Step Deck Support (Late) | 60. Yardarms (Main Mast) |
| 15. Engine Intake Boxes | 38. Auxiliary Coning Position Deck | 61. Yardarm Antenna Loops |
| 16. Fore Mast Top Antenna | 39. Forward Main Deck Walkways | 62. Sea Cat Missiles |
| 17. Exocet Launcher Screens | 40. Port Chaff Deck Extension | 63. Sea Cat Launcher Rails |
| 18. Exocet Launcher Mountings | 41. SCOT Radome Platforms | 64. Corvus Chaff Launchers |
| 19. Hangar Roof Angle Steps | 42. Flight Deck Safety Nets (Aft) | 65. Hull Stiffener Plates |
| 20. Hangar Side Vent Panels | 43. Safety Net Corner Fillers | 66. Propellers |
| 21. Stbd Chaff Deck Extension | 44. Hangar Door Frame | 67. Dan Bouys |
| 22. Lynx Helicopter Tail Rotor | 45. Hangar Door | 68. Anchor Chain |
| 23. Lynx Helicopter Main Rotor | 46. Flight Deck Safety Nets | 69. Vertical Ladder Stock |

General Instructions

- Do not remove the etched parts from the fret until you are ready to use them.
- Before assembly, soak the etched parts in a suitable solvent, such as white spirit, to de-grease the surfaces for painting. It is recommended that the entire fret be primed with an acrylic automotive primer, such as Halfords Grey Primer before assembling any of the parts.
- Cyanoacrylate adhesive (Super glue) or contact adhesive such as a white PVA glue may be used. These can be applied with a pin or piece of stretched sprue.
- When removing parts from the fret, place the fret on a hard surface, such as a smooth ceramic tile, in order to prevent parts bending whilst cutting through the holding tabs. It is suggested that a No.10 rounded type of modelling knife blade is used for this purpose.
- When shaping or bending a part, a straight edged blade such as a chisel blade will give a good sharp corner, or alternatively an Atlantic Models Folding Tool ATT 01 or ATT 02 may be found to be useful
- If a part is bent incorrectly, lay it on a hard flat surface and roll it flat with a cylindrical object such as a modelling knife handle.

20mm Oerlikon Mounting

The gun mountings supplied in the Airfix kit as parts 25 & 26 are probably meant to be 40mm Bofors mountings. These need to be replaced with the 20mm mountings as supplied in this detail set.

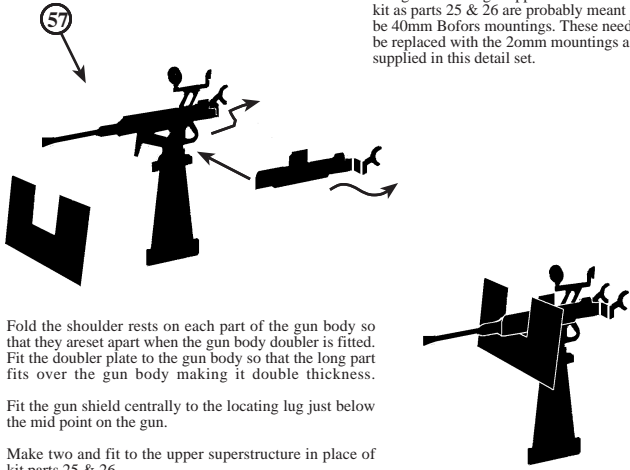

Fold the shoulder rests on each part of the gun body so that they reset apart when the gun body doubler is fitted. Fit the doubler plate to the gun body so that the long part fits over the gun body making it double thickness.

Fit the gun shield centrally to the locating lug just below the mid point on the gun.

Make two and fit to the upper superstructure in place of kit parts 25 & 26.

Sea Cat Missile Launcher

Assemble the Sea Cat missiles using etched parts 62 as shown left. These can be fitted to the launcher as desired. Fit the side rails, etched parts 63, to the short sides of the launcher.

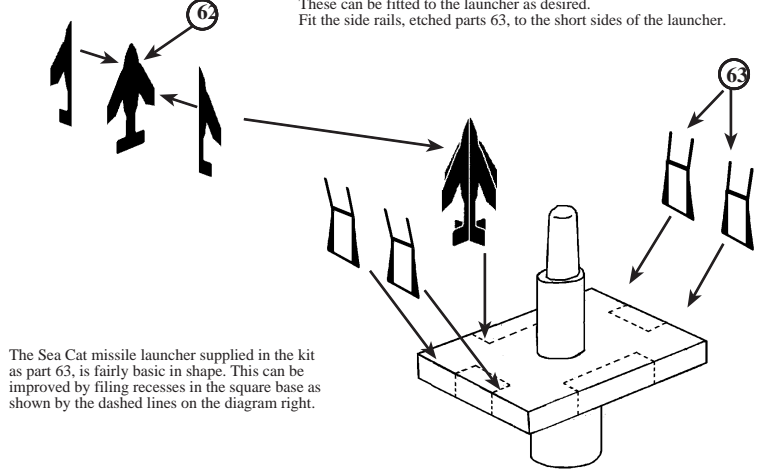

The Sea Cat missile launcher supplied in the kit as part 63, is fairly basic in shape. This can be improved by filing recesses in the square base as shown by the dashed lines on the diagram right.

Corvus Chaff Launcher Assembly

Assemble the corvus chaff launcher, by layering the rocket tubes, etched parts 64 on top of each other, at equal angles left and right. The two tube part is then fitted on top of the others pointing straight out. Fit the assembled tubes centrally to the top of the mounting spindle. The chaff launchers fit into the enclosures, etched parts 52, that are located on the mid superstructure.

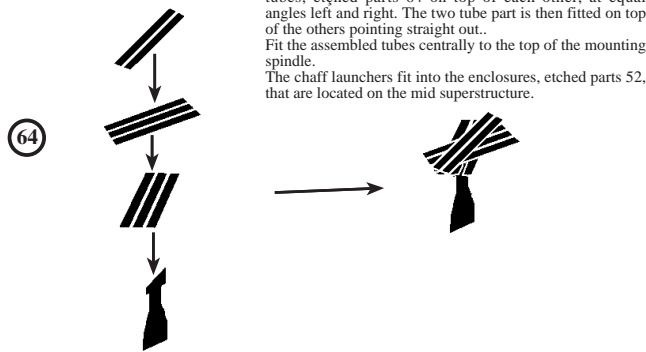

Corvus Chaff Launcher Enclosure Assembly

The chaff launcher enclosures are not included in the kit, but were fitted to all of the Amazon class frigates during their many years of service. There is no easy way of providing these items due to their awkward shape, but to help with a template method of construction.

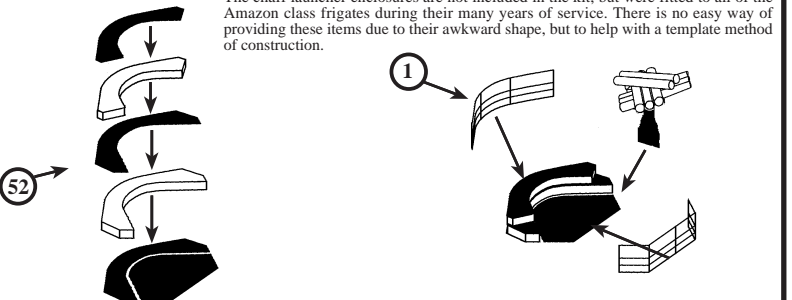

Start with the top level from etched parts 52, laminate the brass top plate to a piece of 20thou thick (0.5mm) plastic card with super glue. Cut the plastic card to the shape of the brass plate. Repeat the process with the second layer which is slightly larger. When the plastic card is shaped into the brass plates, fit the lower layer onto the base plate using the etched line as a locating guide and secure into place. Fit the top layer centrally onto the lower layer, giving a set of steps on each side. Cut and shape the lengths of railing to the edges of the enclosure, from the stock railing supplied. Fit the chaff launcher assembly, centrally onto the base of the enclosure. Make two of these.

Exocet Missile Box Launcher Assembly

There are no Exocet missile containers supplied in the kit, but it is suggested that some may be obtained from the HMS Devonshire kit, that Airfix incorrectly included in that kit when they made up the Falklands special edition anniversary packs. Alternatively it was quite common to find the ships of this class fitted with the Exocet launcher mounting without any containers fitted in place.

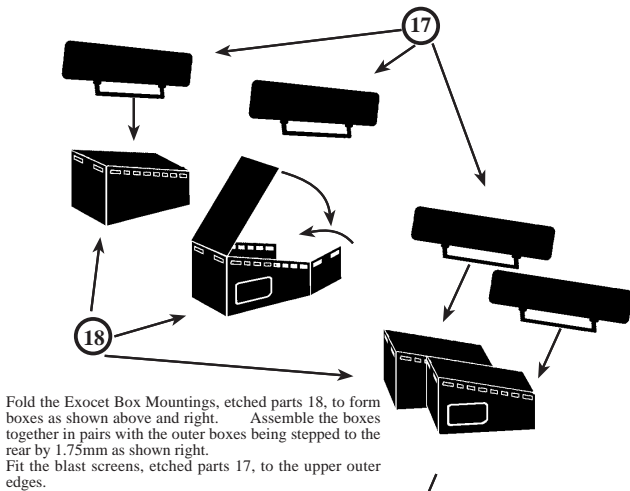

Fold the Exocet Box Mountings, etched parts 18, to form boxes as shown above and right. Assemble the boxes together in pairs with the outer boxes being stepped to the rear by 1.75mm as shown right. Fit the blast screens, etched parts 17, to the upper outer edges.

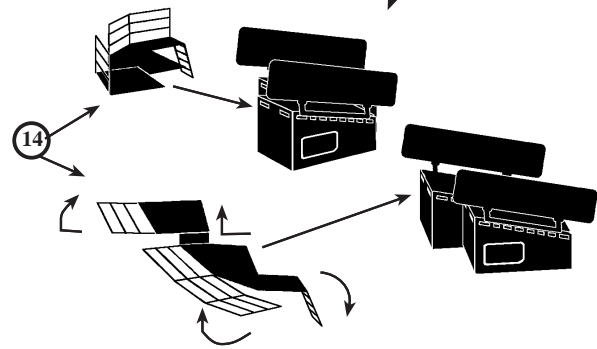

Shape the Exocet Launcher access platforms by stepping up the inner part of the platforms as shown above. Fold the railings sections up to 90° and shape to fit the edges of the platforms. Fit the platforms to the front faces of the launcher boxes, so that the inner platform is just below the castellated section around the top edge. These should be fitted as mirror images to match the launcher mountings.

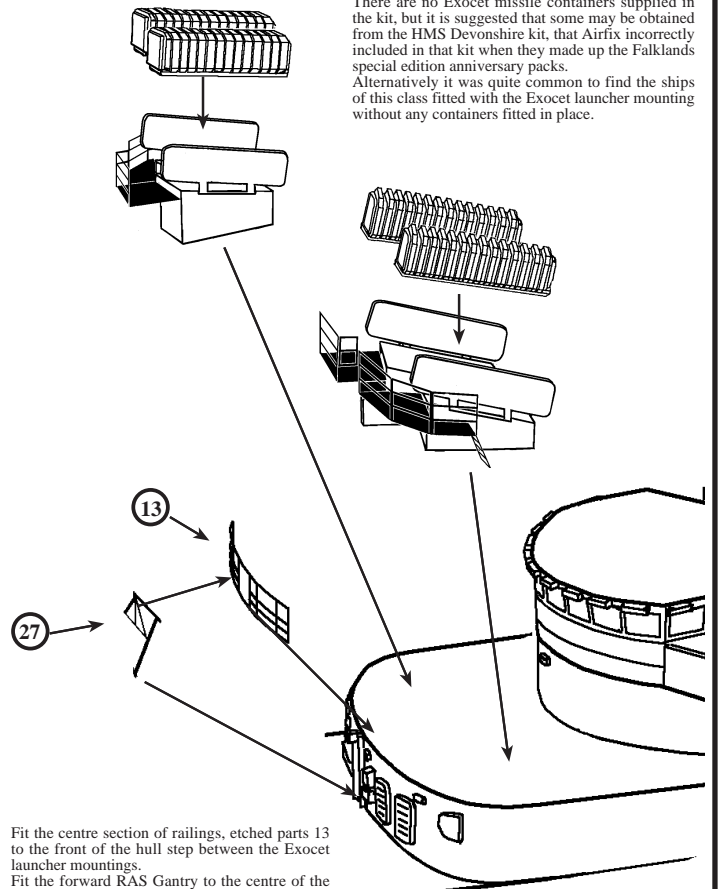

Fit the centre section of railings, etched parts 13 to the front of the hull step between the Exocet launcher mountings. Fit the forward RAS Gantry to the centre of the hull step with the angled frame fitting against the railing section.

Wire Antennas Collector Assembly

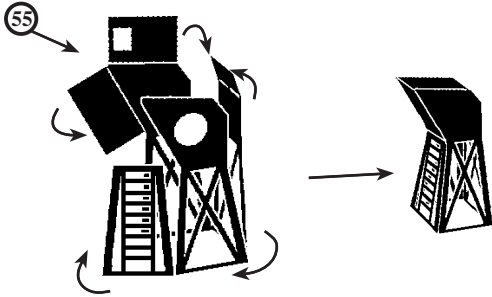

Fold the sides of the wire antenna collector, etched part 55, around so that they are parallel. Angle the cross braced lower sections inwards so that the edges come together at the corners. Secure into place. Fold the top panel and front and rear panels inwards to form an angular box as shown right. This assembly fits on the deck centrally behind the fore mast, and is used to gather the lower ends of the wire antennas trailing down from those strung between the two masts. This assembly replaces kit part 36.

Small Boat Stowage Assembly

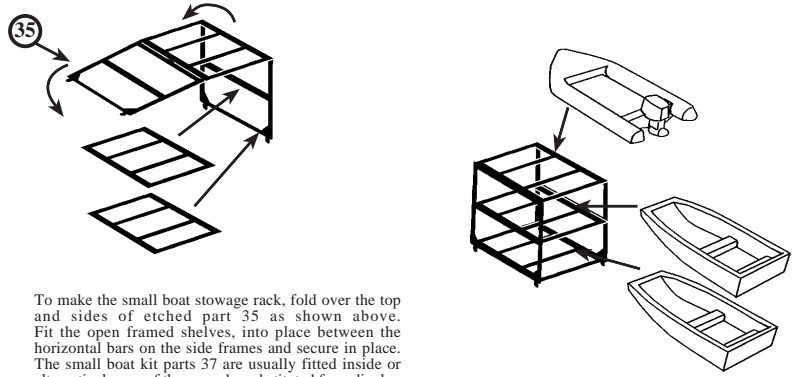

To make the small boat stowage rack, fold over the top and sides of etched part 35 as shown above. Fit the open framed shelves, into place between the horizontal bars on the side frames and secure in place. The small boat kit parts 37 are usually fitted inside or alternatively one of these can be substituted for a dinghy. The Gemini Inflatable is stowed on the top of the rack. This assembly is located on the model just forward of the aft superstructure in a central position amidships..

Dan Buoy Assembly

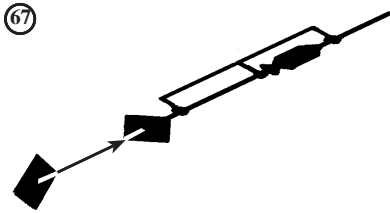

Assemble the radar reflectors on the Dan Buoys, etched parts 67, as shown above. Fit the rectangular bracket arrangement onto the stern railings on the quarterdeck.

The colour of the reflector and body of the Dan Buoys varied from Dayglo Orange which was the most common, to Red and White 90° alternate sections

Chaff Launcher Deck Extension Assembly and Location

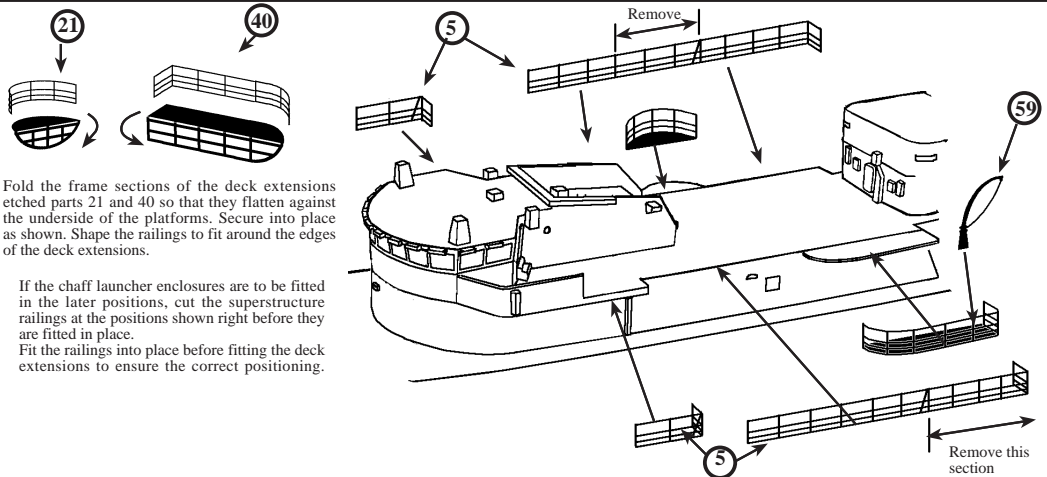

Fold the frame sections of the deck extensions etched parts 21 and 40 so that they flatten against the underside of the platforms. Secure into place as shown. Shape the railings to fit around the edges of the deck extensions.

If the chaff launcher enclosures are to be fitted in the later positions, cut the superstructure railings at the positions shown right before they are fitted in place. Fit the railings into place before fitting the deck extensions to ensure the correct positioning.

Fo'c'sle Railing Location

Gently curve the fo'c'sle railings and shape to fit the anchor recess as shown below.

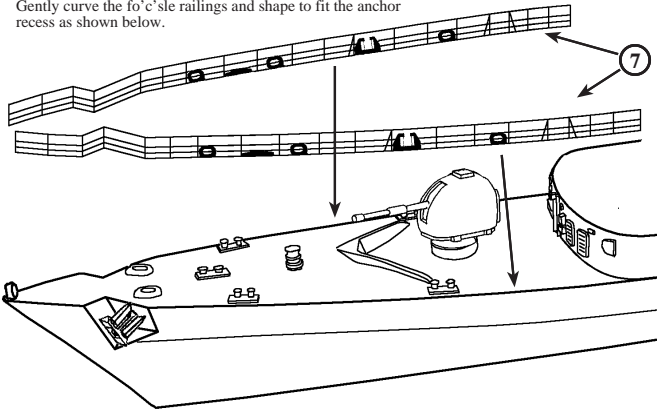

Main Deck Forward Railing Location

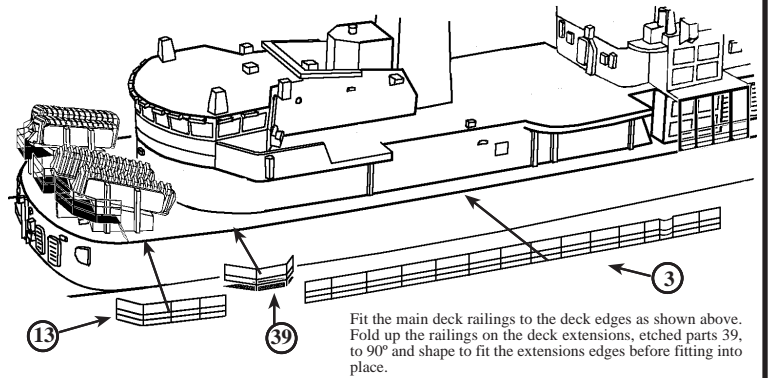

Fit the main deck railings to the deck edges as shown above. Fold up the railings on the deck extensions, etched parts 39, to 90° and shape to fit the extensions edges before fitting into place.

Engine Air Intake Box Assembly

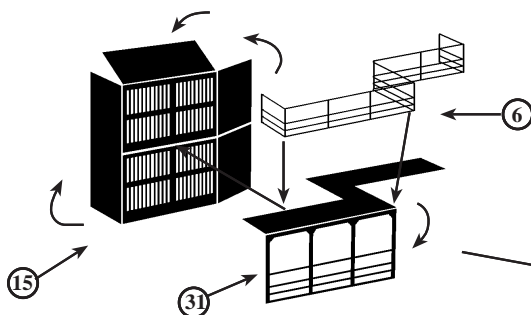

Fold the sides and top of the Air Intakes, etched parts 15, to 90° and secure at the top corners. Ensure that the relief etched detail is outermost. Fold down the support frame on the catwalk, etched part 31, to 90 and fit the catwalks to the relief etched lines on the front and rear faces of the Air Intake boxes. The assembly for the other side of the superstructure must be made as a mirror image to fit correctly. Shape the railing sections, etched parts 6, to fit the edges of the catwalk.

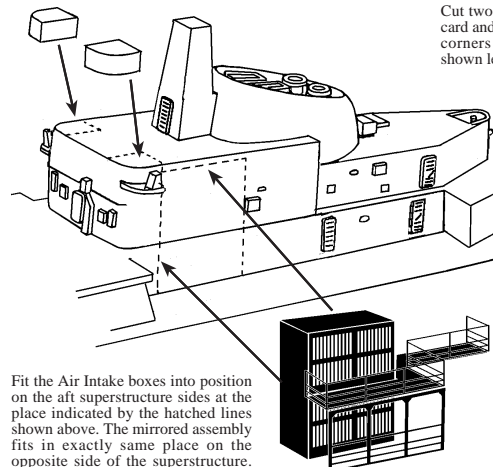

Cut two pieces of 2.5mm thick plastic card and shape to fit the forward upper corners of the aft superstructure as shown left.

Fit the Air Intake boxes into position on the aft superstructure sides at the place indicated by the hatched lines shown above. The mirrored assembly fits in exactly same place on the opposite side of the superstructure.

Fore Mast Fittings Assembly

To fit the details to the fore mast it will be easier to assemble the radar platforms first of all. These replace mouldings on the kit parts 27 and 28 which must first be removed.

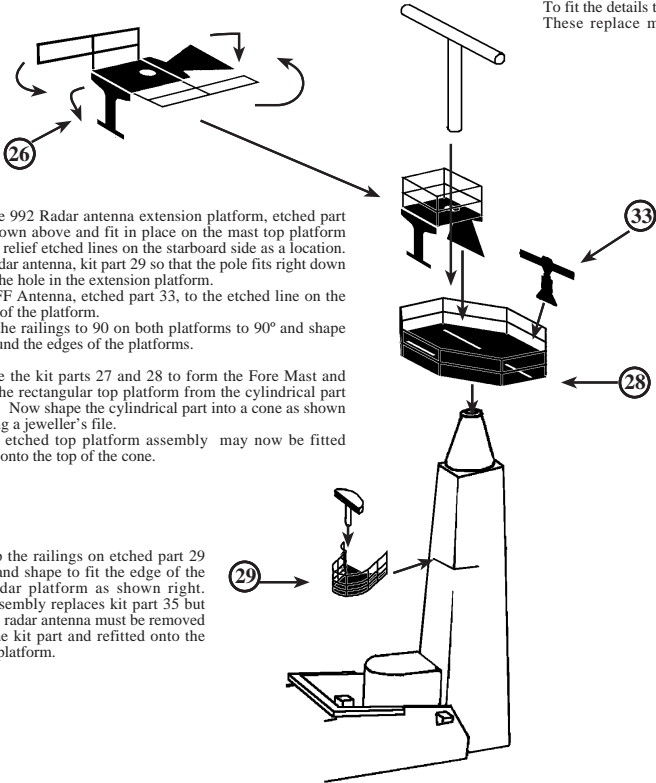

Shape the 992 Radar antenna extension platform, etched part 26, as shown above and fit in place on the mast top platform using the relief etched lines on the starboard side as a location. Fit the radar antenna, kit part 29 so that the pole fits right down through the hole in the extension platform. Fit the IFF Antenna, etched part 33, to the etched line on the port side of the platform. Fold up the railings to 90° on both platforms to 90° and shape to fit around the edges of the platforms.

Assemble the kit parts 27 and 28 to form the Fore Mast and remove the rectangular top platform from the cylindrical part below it. Now shape the cylindrical part into a cone as shown right using a jeweller's file. The new etched top platform assembly may now be fitted centrally onto the top of the cone.

Fold up the railings on etched part 29 to 90° and shape to fit the edge of the Nav radar platform as shown right. This assembly replaces kit part 35 but first the radar antenna must be removed from the kit part and refitted onto the etched platform.

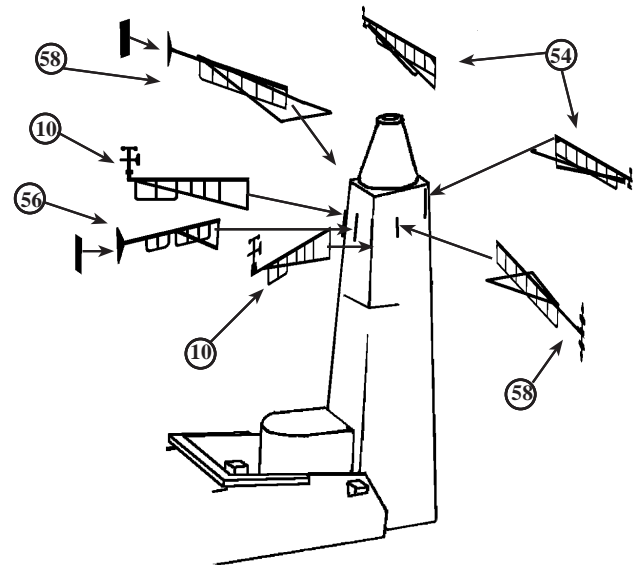

Shape and fit all the Fore Mast Yardarms provided as replacements for kit parts 30,31,32 & 33. The additional front yardarms are not supplied as kit parts but were fitted to the actual ships.

Auxiliary Conning Position

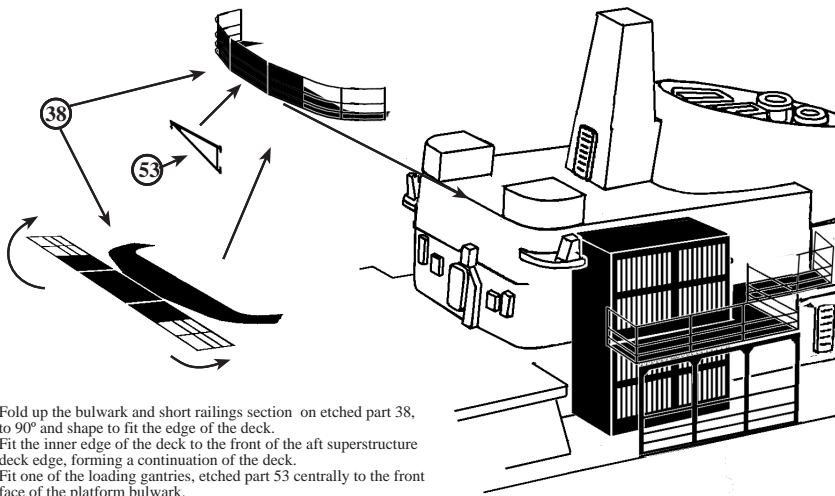

Fold up the bulwark and short railings section on etched part 38, to 90° and shape to fit the edge of the deck. Fit the inner edge of the deck to the front of the aft superstructure deck edge, forming a continuation of the deck. Fit one of the loading gantries, etched part 53 centrally to the front face of the platform bulwark.

Main Mast Assembly

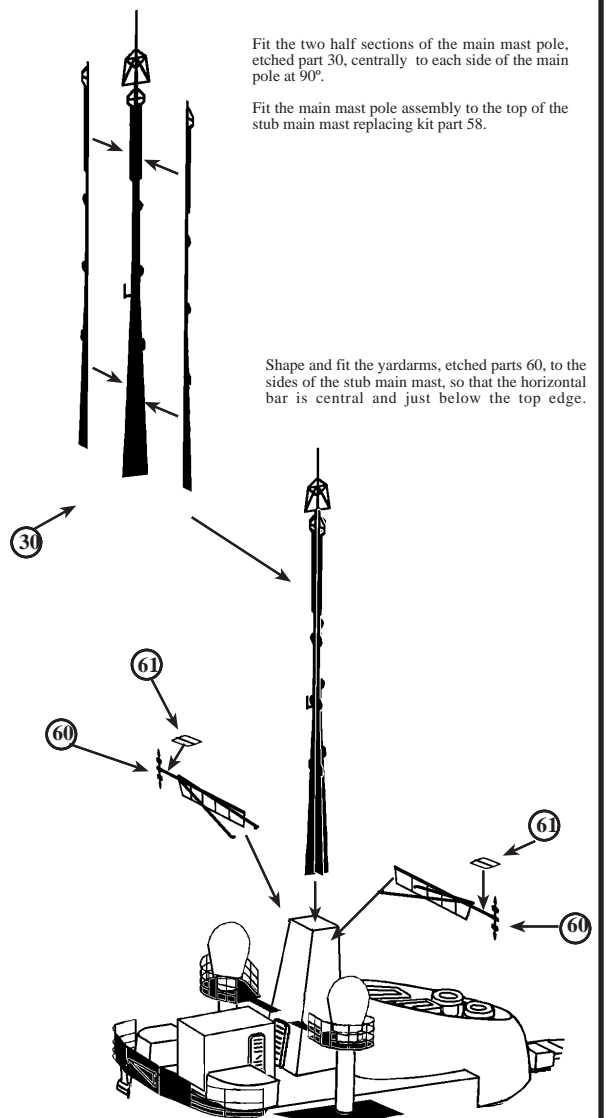

Fit the two half sections of the main mast pole, etched part 30, centrally to each side of the main pole at 90°.

Fit the main mast pole assembly to the top of the stub main mast replacing kit part 58.

Shape and fit the yardarms, etched parts 60, to the sides of the stub main mast, so that the horizontal bar is central and just below the top edge.

SCOT Platform Assembly and Location

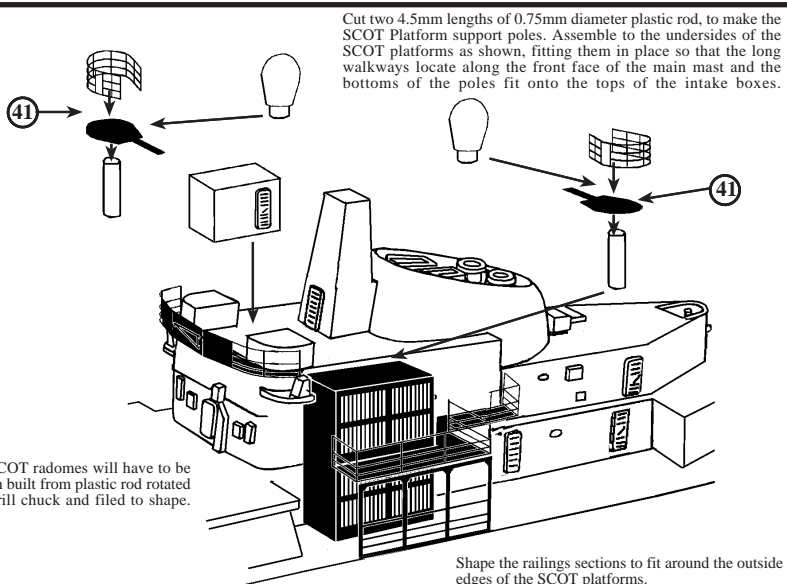

Cut two 4.5mm lengths of 0.75mm diameter plastic rod, to make the SCOT Platform support poles. Assemble to the undersides of the SCOT platforms as shown, fitting them in place so that the long walkways locate along the front face of the main mast and the bottoms of the poles fit onto the tops of the intake boxes.

The SCOT radomes will have to be scratch built from plastic rod rotated in a drill chuck and filed to shape.

Shape the railings sections to fit around the outside edges of the SCOT platforms.

Boat Davit Assembly and Location

Fit the boat davits into position on the ships side using the attachment plates on the railings sections, etched part 4 as a location guide. See Next Section. To fit the boats to the davits, cut through the bottoms of the falls and pull them out almost horizontal. Drill small holes right through the boats at the positions that the falls will be adjacent to when placed alongside the boats. Once the holes have been drilled, pass the davit falls through the holes so that the boat slides up into position in the davits. Secure the boat into place by re attaching the bottom of the falls to the davit legs.

Fold the boat davits, etched parts 48, in half with the relief detail outermost. Secure into place.

To position the hull stiffeners, etched parts 65 on each side of the hull, draw a line vertically downwards from the point of the V at the aft hull step. Draw another line horizontally along from the flight deck. Where the two lines meet is where the aft point of the stiffener is located.

Fit the hull stiffener along a horizontal line drawn from the flight deck.

Hangar and Aft Superstructure Details

Fold the floodlight support frames on etched parts 50 up to 90° then fold the railings around to 90° and attach to the edge of the small deck plate. Fit the floodlight platforms to the rear edges of the main deck at the sides of the hangar door.

Fit the railing section, etched part 4, to the main deck edge. Cut a short length of stock railing to continue the railing run aft of the torpedo tubes.

Smooth the plastic hangar door surround on the kit parts and fit etched part 44 into place on the outer face as shown above. The hangar door can now be correctly located in the frame either fully closed or partially open, by cutting it to the height required. Cut the side vent boxes on the kit parts to the shape shown above and replace the rear angled faces with the etched parts 20. Fold the small attachment bar on the approach light beam, etched part 8, to 90° and fix to the rear edge of the hangar roof. Fit the railing sections, etched parts 11 to each side of the hangar roof, shaping to fit around the sides of the vent boxes as shown.

Flight Deck Fittings

Fit the rear flight deck safety nets, etched parts 42 to the rear of the flight deck. These may be fitted raised by cutting and separating the sections at the angles. Use the triangular to fill in the corners.

Fit the flight deck safety nets etched parts 46 to the sides of the flight deck. These may be fitted raised or lowered.

A choice of support fairings has been supplied in etched parts 36 and 37. The enclosed supports are fitted later in the ships careers. Each are fitted in the same way. Fit the short section of railings, etched parts 6, aft of the deck support fairings.

Quarterdeck Fittings

Fold the decoy crane, etched part 51, in half so that the two sides form a V. Cut a small length of plastic rod as a base to mount the crane onto.

Shape and fit the railings, etched part 12, to the outer edge of the quarter deck.

Lynx Helicopter Details

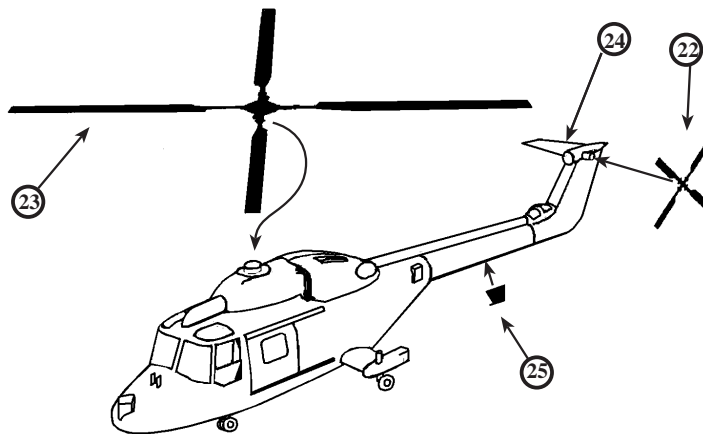

Fit the main and tail rotor blades, etched parts 23 and 22, as shown above.
Fit the blade aerial 25 to the underside of the tail cone.

Other Instructions

1. Etched parts 47 are a more accurately shape main funnel uptake exhaust. The cluster of round mouldings at the front of the funnel top cap should be removed and replaced with the two oval items provided after first folding them in half, and fitting in place side by side with the grill uppermost.
2. Enough anchor chain, etched part 68, has been supplied to allow the ship to be modelled at anchor with the anchor chain streamed out from the hawse pipes to the surface of the water if desired.
3. Stock lengths of vertical ladders, etched parts 69, have been supplied to provide ladders for any of the superstructure sides, upper decks and mast platforms. The ladders may be cut to the lengths required and fitted into place with super glue.
4. Signal Lamps, etched parts 32, have been supplied and are fitted to each side of the ship on the bridge wings and signal deck. Further research may be required to establish the exact locations of these items.
5. Etched parts 66 are replacement propeller blades that may be used if desired. The propellers provided in the kit are of reasonable quality, but the blades may be removed from the hub and the hub retained and fixed centrally onto the photo etched propeller blades.