

**British 'V' Class Destroyer**  
**H.M.S. VIGILANT**  
**1944**

**8th Emergency Flotilla**  
 Resin & Photoetched Metal Kit in 1/350 scale

**History**

*HMS Vigilant* was laid down by Swan Hunters Shipbuilding, at Wallsend on 31 January 1942, launched within the year on 22 December 1942, & completed on 10 September 1943, which also included extra protection for Arctic service. From her commissioning in late 1943 to mid-1944 *Vigilant* served on Russian convoy duties, until May 1944 when she was required in the Channel for operations relating to D-Day. She provided convoy escort and naval gunfire support for the troops ashore until mid-July when she rejoined her flotilla. This was followed by a period of escort duties for various elements of the fleet that involved the whole flotilla until December 1944 when preparations were made for a deployment to the Eastern Fleet, which took place in mid-January 1945 & saw *Vigilant* arrive in Trincomalee escorting the carrier *HMS Formidable*. During the next few weeks *HMS Vigilant* was involved in screening duties for various operations. In March she was part of an operation that resulted in the sinking of 4 Japanese merchant ships & their 2 escorts. In April & May she joined with other destroyers for operation Sunfish, bombarding Oleelhoe.

In May 1945 during operation Bishop, *HMS Vigilant* deployed with *HMS Saumarez*, *Verulam*, *Venus* & *Virago* to intercept Japanese ships that had been sighted in the entrance to the Malacca Straits. On the 15 May the destroyers engaged the Japanese cruiser *Haguro* & destroyer *Kamikaze*, sinking the *Haguro* in a brilliant night torpedo attack in the Malacca Straits southwest of Penang.

*HMS Vigilant* continued with her escort duties through to August 1945, after which she returned to the UK after the surrender of Singapore. *Vigilant* was retained in service after WW2 & was attached to the Londonderry ASW training flotilla until 1947, when she was paid off into reserve at Portsmouth. *Vigilant* was later taken in hand & converted to a Type 15 frigate, which extended her service until the mid-1960s. *HMS Vigilant* was sold for scrap & went to the breakers in June 1965

**Specifications**

Length: 362ft 9in oa. Beam: 35ft 8in Displacement: 1,808 tons standard, 2,530 tons full load. Speed: 36 knots max

Armament: 4 x 4.7inch QF guns in single MkIX mounts. 8 x 21inch Torpedo Tubes in two quadruple mounts.  
 Depth Charges from 2 stern rails & 4 Mk 11 depth charge throwers. 4 x 20mm Twin Oerlikon Powered mounts  
 1 x Twin 40mm Hazemeyer Mount

This kit contains a mixture of resin and photoetched metal small parts, of which some of the resin parts have been attached to sprues for ease of casting. Care must be taken when detaching the parts from the sprues, to remove the flash without causing damage. When cleaning off the excess material using files or abrasive paper, we recommend that a mask is worn as resin dust can be an irritant if inhaled.

**Resin and Metal Parts Identification**

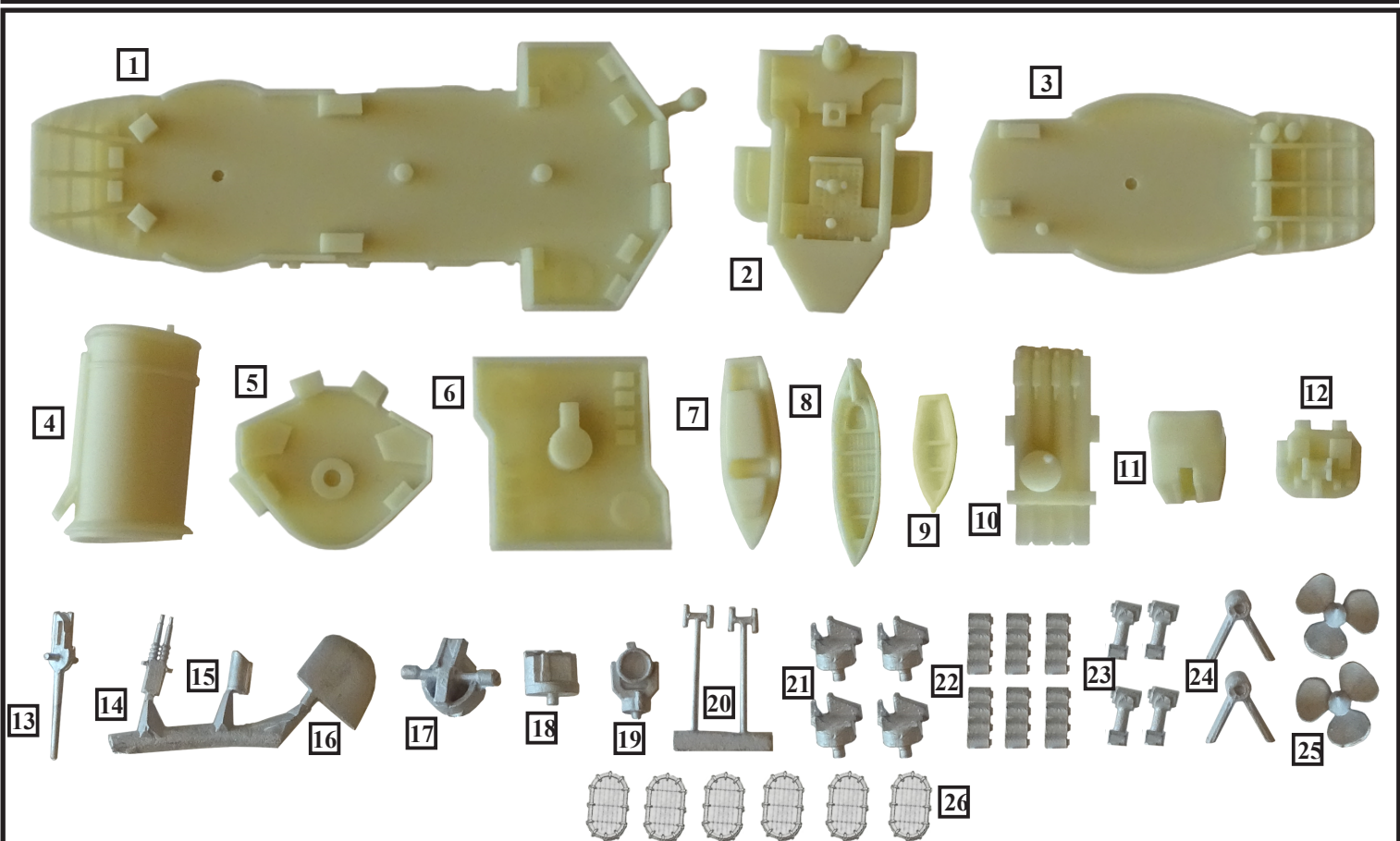

- |                           |                                  |                               |
|---------------------------|----------------------------------|-------------------------------|
| 1. Forward Superstructure | 10. 21" Torpedo Tubes            | 19. Searchlight Projector     |
| 2. Bridge                 | 11. 4.7" Gun Mount Mk XXII x 4   | 20. Stove Pipes               |
| 3. Aft Superstructure     | 12. 40mm Bofors Twin Mount       | 21. Twin 20mm Oerlikon Mounts |
| 4. Funnel                 | 13. 4.7" Gun Barrel x 4          | 22. Depth Charge Rails        |
| 5. Hazemeyer Platform     | 14. 40mm Twin Bofors Barrels     | 23. Depth Charge Throwers     |
| 6. 20mm AA Platform       | 15. Crow's Nest                  | 24. Propeller A Frames        |
| 7. 25' Motor Cutter       | 16. Rudder                       | 25. Propellers (Pair)         |
| 8. 27' Whaler             | 17. HACs Mk3 Director            | 26. Carley Rafts              |
| 9. 16' Dinghy             | 18. Director Control Tower (DCT) |                               |

## Photoetched Parts Identification

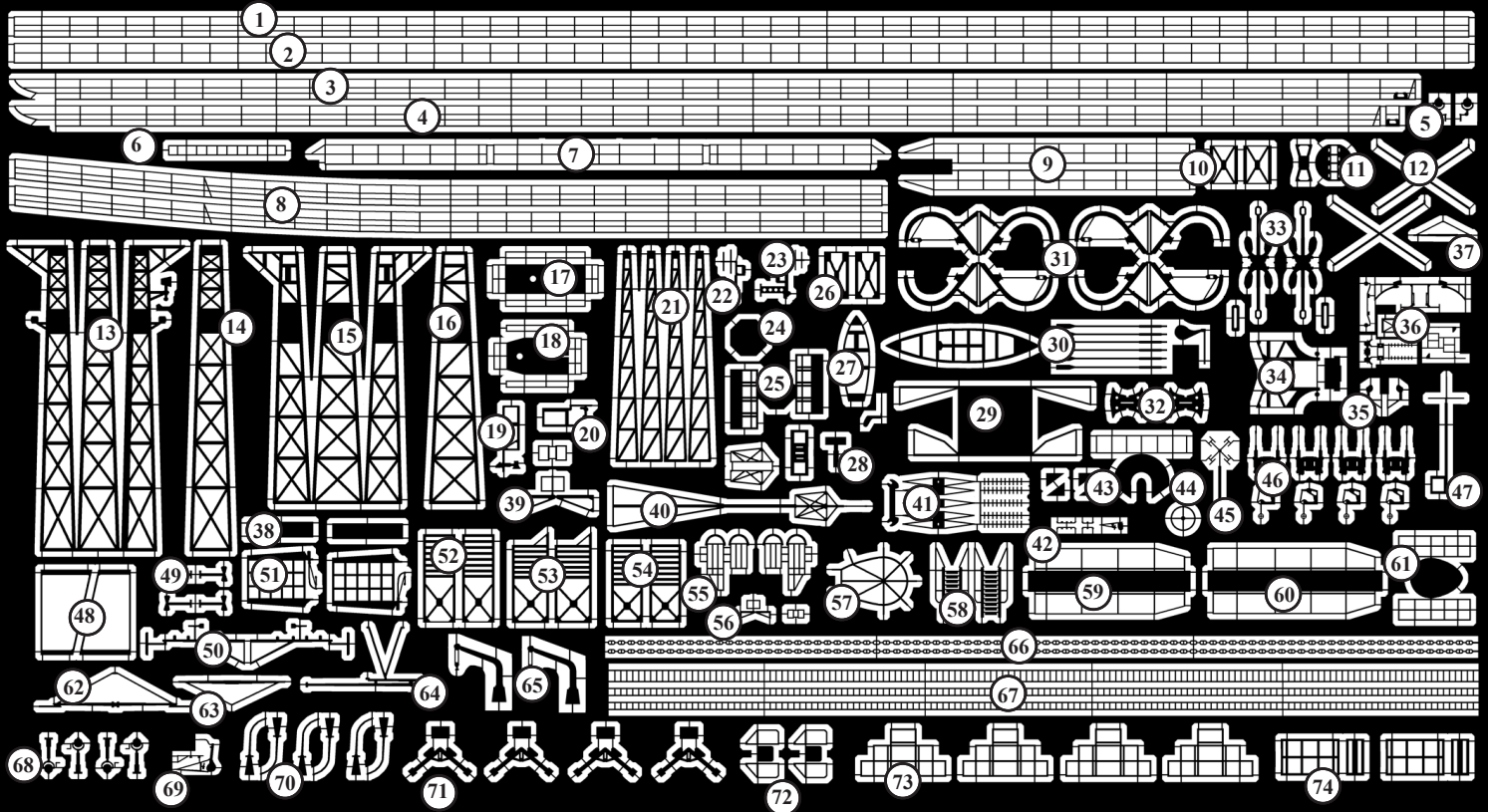

- |  |  |                                 |                                  |
|--|--|---------------------------------|----------------------------------|
| 1. Standard 3-Bar Railing Stock                | 19. Mast Top Platform Forward Yard                 | 38. Depth Charge Rail Plates    | 57. Funnel Cap Grille            |
| 2. 2-Bar Railing Stock                         | 20. Mast Top Platform Fwd Yard ( <i>Vigilant</i> ) | 39. Bridge Front DF Antenna     | 58. Hull Step Inclined Ladders   |
| 3. Railings (Main Deck Starboard)              | 21. Mainmast Lattice                               | 40. MF/DF Antenna Pole          | 59. Forward Torpedo Tube Catwalk |
| 4. Railings (Main Deck Port)                   | 22. IFF Interogator Antenna                        | 41. 285 Radar Yagi Antenna      | 60. Aft Torpedo Tube Catwalk     |
| 5. Signal Lamps                                | 23. IFF Interogator Antenna                        | 42. Motor Boat Fittings         | 61. Searchlight Platform         |
| 6. Bridge Windows                              | 24. Radar Lantern Top Plate                        | 43. HACs Director Catwalk       | 62. Tripod Foremast Lower Yard   |
| 7. Railings (Aft Gun Deck)                     | 25. 276 Radar Lantern                              | 44. Searchlight Lens Cross      | 63. Tripod Foremast Upper Yard   |
| 8. Railings (Foc'sle)                          | 26. Forward Gun Platform Supports                  | 45. 291 Radar Antenna           | 64. Jackstaff                    |
| 9. Railings (Forward Gun Deck)                 | 27. 16' Dinghy Thwarts & Rudder                    | 46. 20mm Twin Oerlikon Parts    | 65. Torpedo Loading Cranes       |
| 10. Bridge Extension Supports                  | 28. 276 Radar Antenna                              | 47. Tripod Foremast Top Antenna | 66. Anchor Chain                 |
| 11. 293 Radar Antenna                          | 29. Bridge Canopy                                  | 48. Tripod Foremast Leg Spacers | 67. Stock Vertical Ladder        |
| 12. Boat Restrainer Straps                     | 30. 27' Whaler Thwarts & Rudder                    | 49. IFF Transponders            | 68. Signal Lamps (Large)         |
| 13. Foremast Lattice ( <i>Scorpion</i> )       | 31. Boat Davits                                    | 50. Lattice Mast Yardarms       | 69. Motor Boat Running Gear      |
| 14. Foremast Front Lattice ( <i>Scorpion</i> ) | 32. 16' Dinghy Cradles                             | 51. Depth Charge Rail Cages     | 70. Depth Charge Loading Davits  |
| 15. Foremast Lattice ( <i>Vigilant</i> )       | 33. Anchors  | 52. Carley Raft Rack (Forward)  | 71. Depth Charge Throwers (Alt)  |
| 16. Foremast Front Lattice ( <i>Vigilant</i> ) | 34. Stern TSDS Gantry                              | 53. Carley Raft Rack (Midships) | 72. Funnel Siren Platforms       |
| 17. Mast Top Platform ( <i>Scorpion</i> )      | 35. Funnel Sirens                                  | 54. Carley Raft Racks (Aft)     | 73. Depth Charge Thrower Racks   |
| 18. Mast Top Platform ( <i>Vigilant</i> )      | 36. Hazemeyer Yagi Support Frame                   | 55. Flare Rocket Launcher Rails | 74. Depth Charge Stowage Racks   |
|  | 37. Pole Mainmast Yardarm                          | 56. DF Antenna                  |                                  |

## Other Instructions

- Railings, etched parts 1, have been supplied as stock length so that they can be cut to length to fit any shortfalls in the tailored-to-fit railings supplied. Also some small lengths will be required at the aft end of the foc'sle deck and the lower superstructure decks. Etched parts 2 are stock 2-bar railings, with both wide & close stanchions. These can be cut & combined to fit lengths of upper deck platforms & deck edges as desired.
- Etched part 67 is a stock length of vertical ladder. This can be cut into lengths necessary to fit up mast poles as well as access platforms & sides of deck houses.
- Metal parts 20 are stove pipes. These may be fitted, if desired, to the roof of the aft superstructure. (See colour guide profiles for the location)
- Etched parts 58 are the two inclined ladders that run from the main deck up to the foc'sle deck at the hull step. They are located within a rectangular opening in the foc'sle deck overhang, so that the top of each ladder is still located against the vertical bulkhead of the foc'sle.
- Anchor chain, etched part 66, is supplied in sufficient quantity to not only fit between the capstans & hawsepipes on the foc'sle, but also to provide extra should the model be portrayed at anchor with a chain running from the hawsepipe to the surface of a seascape.
- Etched parts 12 are the retaining straps that are fitted across the outsides of the ship's boats between the davits. These can be cut to length to fit as necessary.
- Etched parts 27 & 30 are the fittings for the 16' Dinghy & the 27' Whaler. The thwarts & rudders are fitted in both boats in the same manner, & the method is described in a later section. The oars can be cut & placed individually in the boats, or rolled in to bundles for stowage on bulkheads.
- Some resin parts in this kit have been duplicated or replaced with photoetched parts that can be used as alternatives where the casting detail has been compromised.
- References for this class of destroyer are available in various books & on the internet. One example is the new publication by Norman Friedman titled *British Destroyers and Frigates*. Other references can be found in *Destroyers of World War Two* by M.J. Whitley and, if one can be obtained, the older out-of-print publication *British Destroyers* by Edgar March is a wealth of information.

ATLANTIC MODELS © 2016

1 Hillview Grove, Easington, Durham, SR8 3NT. UK Tel. 0191 5271574  
e.mail: peter@atlanticmodels.net Website <http://www.atlanticmodels.net>

## Main Parts Location Diagram

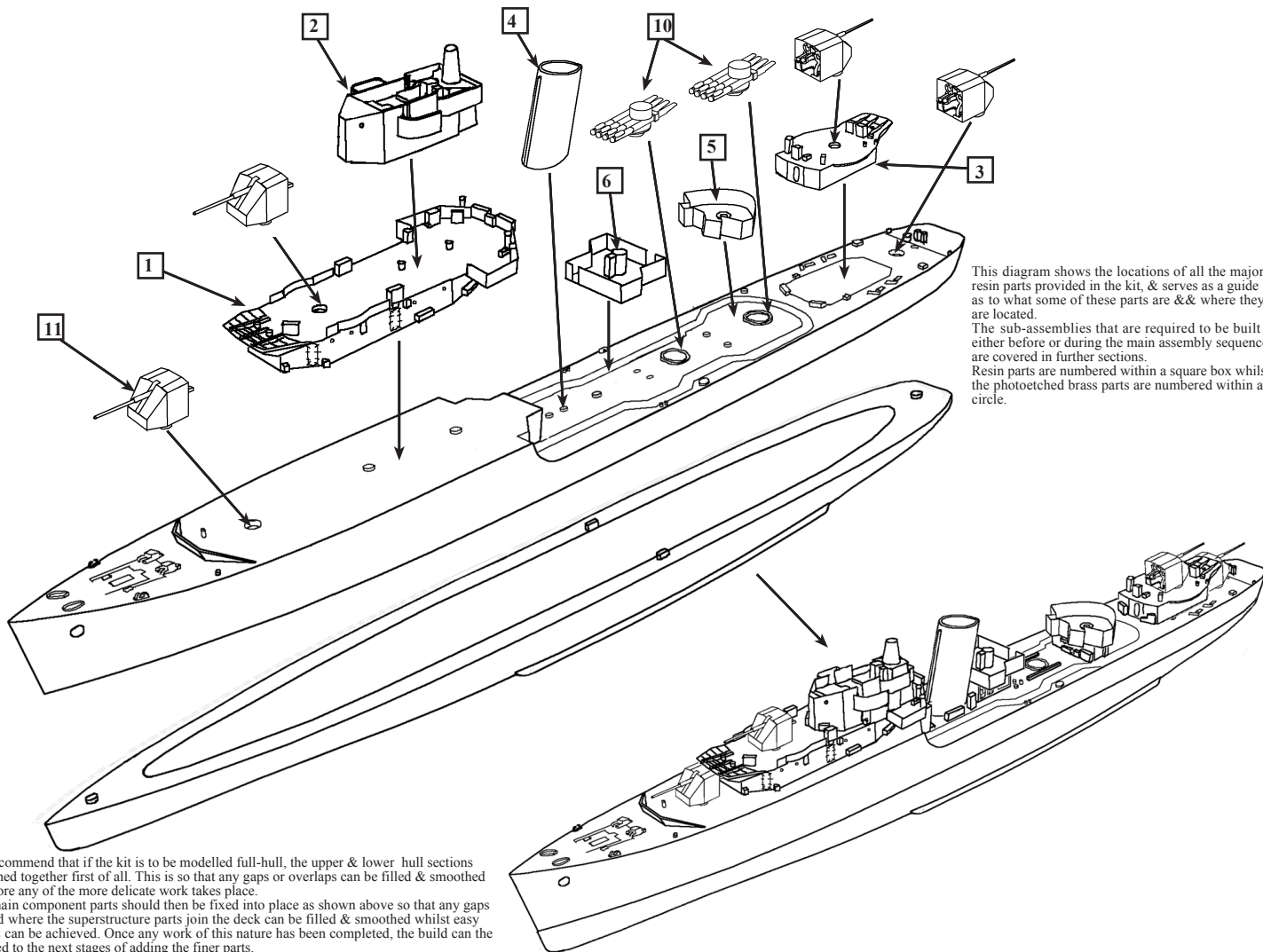

This diagram shows the locations of all the major resin parts provided in the kit, & serves as a guide as to what some of these parts are && where they are located. The sub-assemblies that are required to be built either before or during the main assembly sequence are covered in further sections. Resin parts are numbered within a square box whilst the photoetched brass parts are numbered within a circle.

We recommend that if the kit is to be modelled full-hull, the upper & lower hull sections be joined together first of all. This is so that any gaps or overlaps can be filled & smoothed in before any of the more delicate work takes place. The main component parts should then be fixed into place as shown above so that any gaps around where the superstructure parts join the deck can be filled & smoothed whilst easy access can be achieved. Once any work of this nature has been completed, the build can proceed to the next stages of adding the finer parts.

### 4.7" Single Gun Mount Assembly

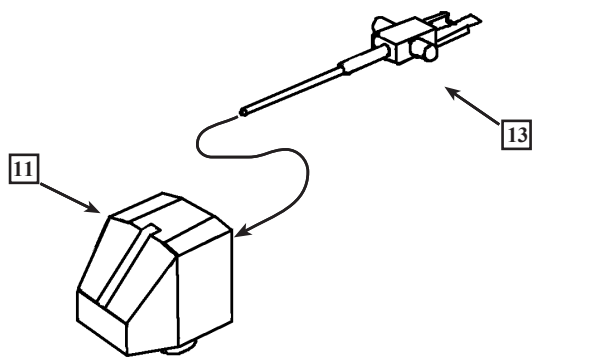

Fit the 4.7" gun, metal part 13, so that the elevating hinges fit in to the recesses on top of the gun mount inside the gun shield, resin part 11. It may be necessary to clean away excess resin moulding debris from the tops of the mount to allow the gun hinges to fit properly. Make 4 of these.

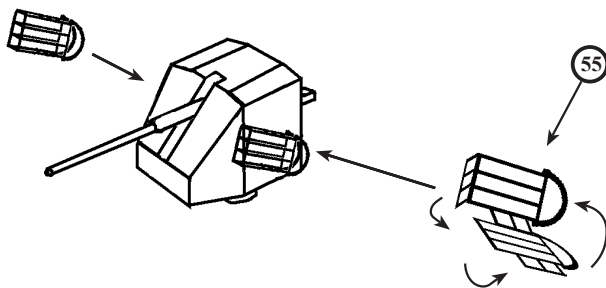

Fold the flare rocket launch rails, etched parts 55, to shape shown and fit to each side of the gun mounting in 'B' position.

### 40mm Twin Bofors Assembly (Hazemeyer)

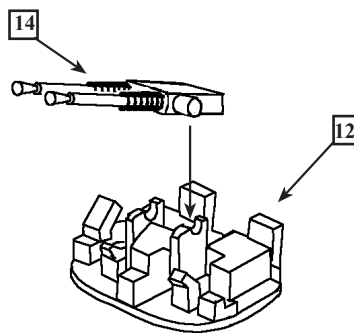

Fold the central mounting frame, part 36A, so that the sides are parallel. Fit the frame so that the main legs fit behind the gun barrels & the small forward feet fit on top of the gun body. Fit a small strip of thin (10 thou) plasticard across the top of the frame on which to mount the yagi antenna as shown left. Fit the rear railings & gunsights to the positions shown.

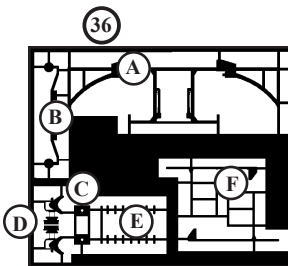

Assemble the yagi radar antennas by curving the rectangular dishes of etched parts 36C as shown. Fit the dipoles into the holes in the centre of the dishes so that they are parallel. Fold part 36D in half so that the etched detail is outermost, then attach centrally to the two joining bars between the radar dishes.

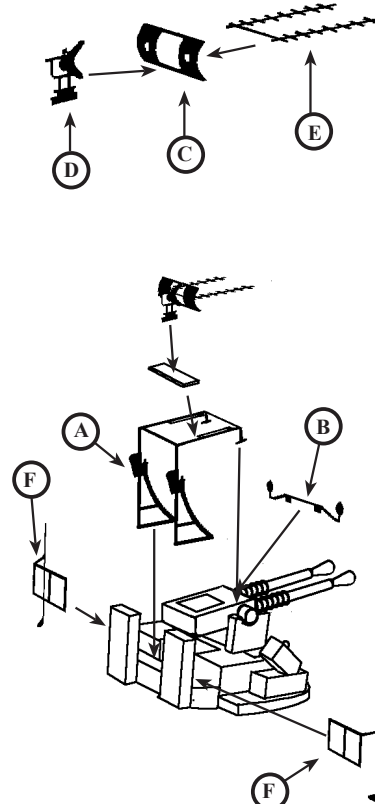

### 20mm Twin Oerlikon Mounts

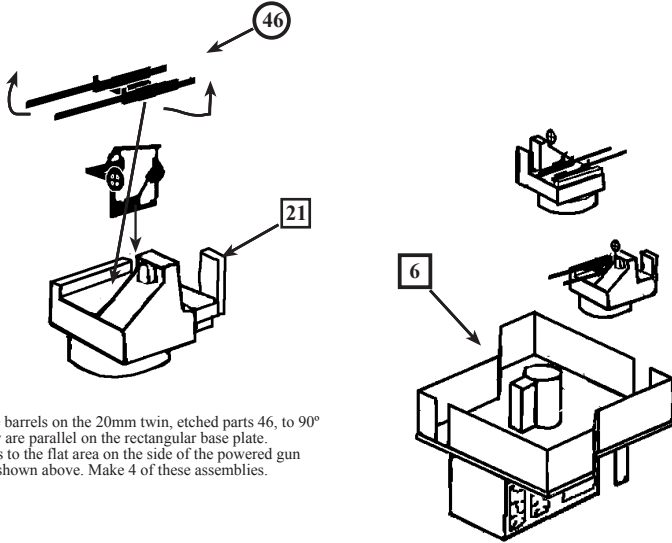

Fold up the barrels on the 20mm twin, etched parts 46, to 90° so that they are parallel on the rectangular base plate. Fit the guns to the flat area on the side of the powered gun mounts as shown above. Make 4 of these assemblies.

Remove any flash or molded bulwarks from the edges of the 20mm Oerlikon platform, resin part 6.  
Fit the platform to the ship's hull so that the locating pegs & holes on the deck align.  
Fit the assembled 20mm powered mounts as shown above.

### Searchlight Platform Assembly

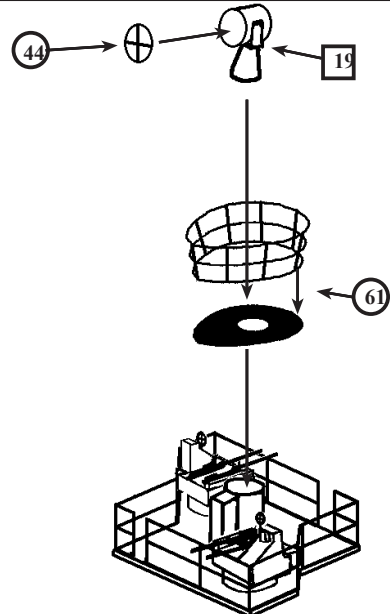

Fit the searchlight platform, etched part 61, to the mounting in the centre of the Oerlikon platform. Shape & fit the railing to the edge of the searchlight platform. Fit the lens cross, photoetched part 15, to the front of the searchlight as shown. Fit the searchlight so that the locating lug on the base passes through the hole in the platform & locates into the hole on the top of the platform support.

### 40mm Bofors Platform Assembly

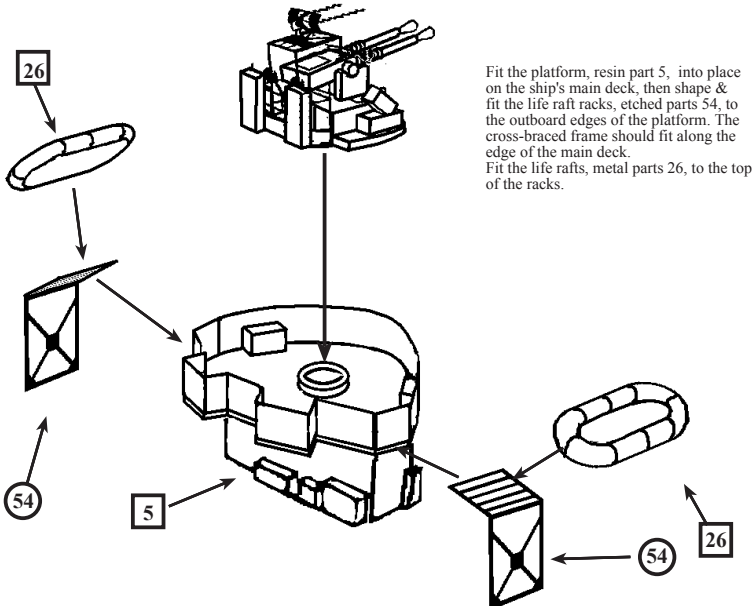

Fit the platform, resin part 5, into place on the ship's main deck, then shape & fit the life raft racks, etched parts 54, to the outboard edges of the platform. The cross-braced frame should fit along the edge of the main deck.  
Fit the life rafts, metal parts 26, to the top of the racks.

### Midships Carley Raft Racks

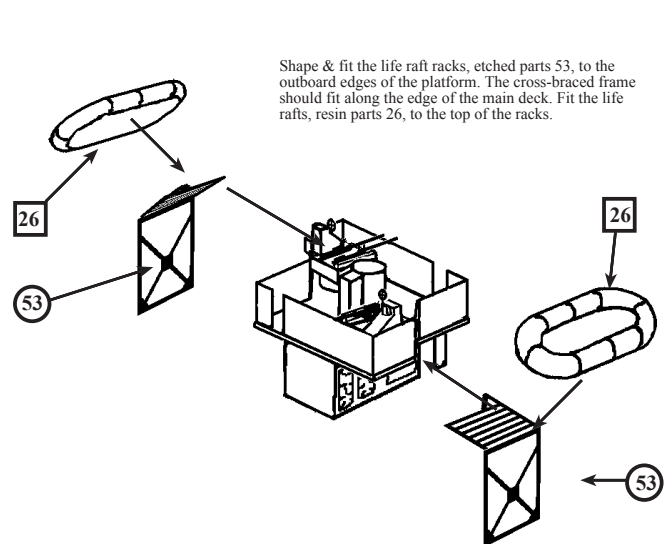

Shape & fit the life raft racks, etched parts 53, to the outboard edges of the platform. The cross-braced frame should fit along the edge of the main deck. Fit the life rafts, resin parts 26, to the top of the racks.

### 285 Radar Yagi Antenna

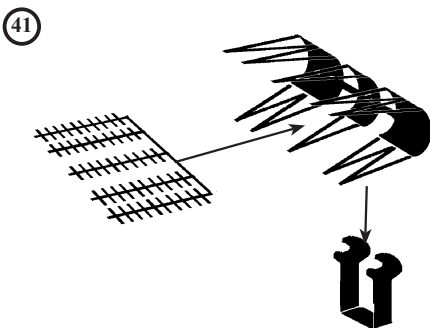

Assemble the 285 Fire Control antenna by folding a gentle curve onto the rectangular reflectors, then fold over the stays so that they face forwards.  
Fit the set of dipoles centrally onto the reflector faces.  
Nip the pointed ends of the stays together so that they trap the centre bar of the dipoles between them. Fit the mounting arms to the spindles between the reflectors.  
The complete assembly then fits onto the top of the HACs director, metal part 17, so that the points face over the front of the director.

### Bridge Fittings Location

Shape & fit the bridge canopy, etched part 29, if desired. This is an optional part that was not always fitted.

Fit the directors, supplied as kit parts, in to place as shown below.  
Shape & fit the HACs director access platform, etched part 43, to the HACs tower. Stock lengths of ladder, etched part 67, may be used at each end of this platform assembly.

Fit the bridge windscreen panel, etched part 6, into place as shown

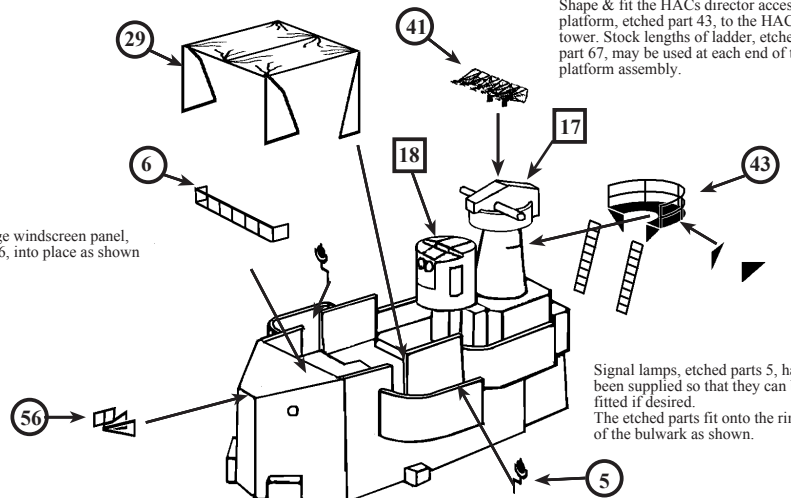

Shape & fit the bridge front DF antenna, etched part 56, as shown above.

Signal lamps, etched parts 5, have been supplied so that they can be fitted if desired.  
The etched parts fit onto the rim of the bulwark as shown.

### Forward Superstructure Fittings

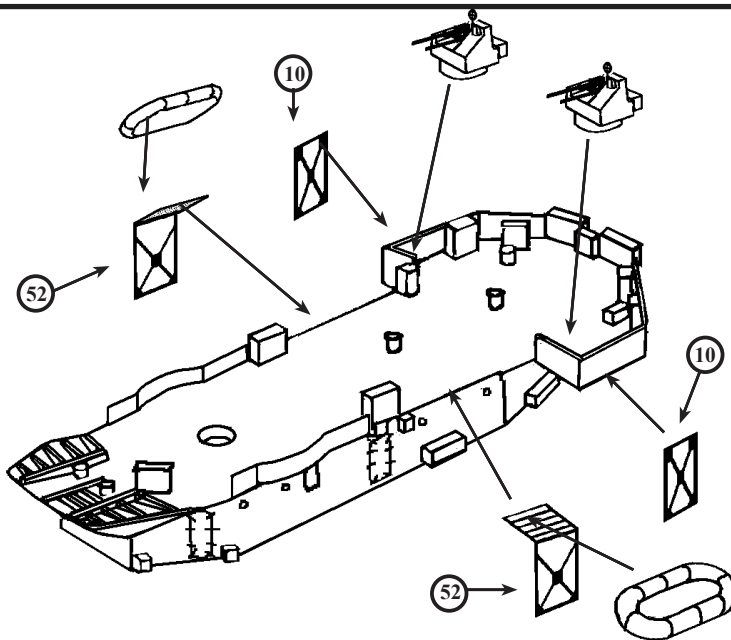

Shape and fit the life raft racks, etched parts 52, to the outboard edges of the gun deck. The cross-braced frame should fit along the edge of the main deck. This is an alternative position for these racks. Fit the gun platform supports, etched parts 10, under the Oerlikon platform extensions, so that the lower edge fits along the edge of the main deck.

### Tripod Foremast Assembly

Fit the yardarms, etched parts 62 and 63, as shown. These may be reinforced using 0.5mm (20 thou) brass rod cut to length & fitted along the spars.

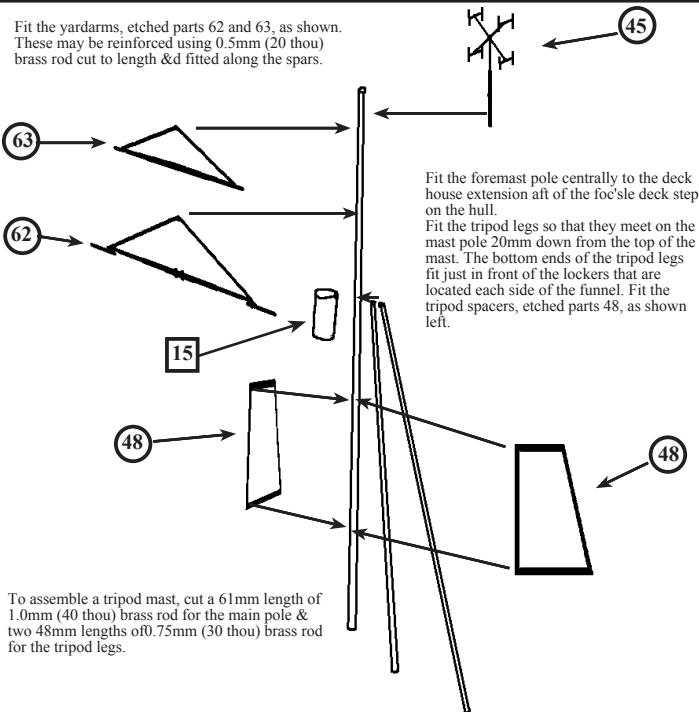

Fit the foremast pole centrally to the deck house extension aft of the foc'sle deck step on the hull.  
Fit the tripod legs so that they meet on the mast pole 20mm down from the top of the mast. The bottom ends of the tripod legs fit just in front of the lockers that are located each side of the funnel. Fit the tripod spacers, etched parts 48, as shown left.

To assemble a tripod mast, cut a 61mm length of 1.0mm (40 thou) brass rod for the main pole & two 48mm lengths of 0.75mm (30 thou) brass rod for the tripod legs.

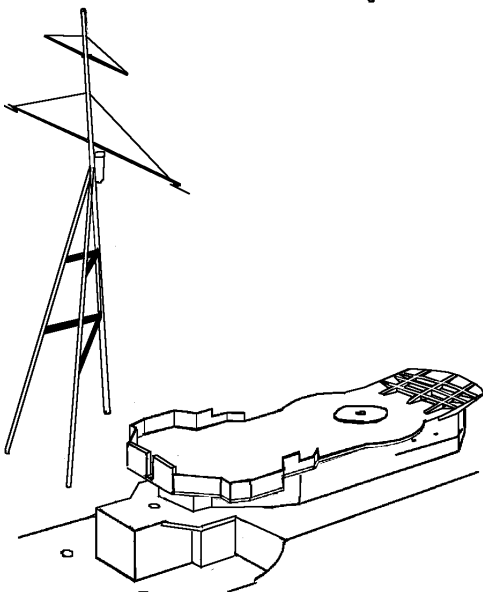

### 291 Radar Antenna

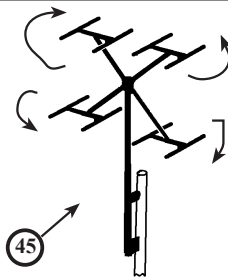

The 291 radar antenna is folded into shape by bending the outer dipoles so that they face in the direction shown above. This antenna is fitted to the very top of the mast top pole.

### MF/DF Antenna

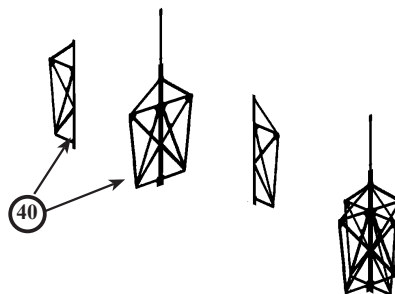

Assemble the MF/DF antenna by folding each of the two halves down the centre line to 90°. Join the halves together by glueing down the centre line and positioning the parts to form a cross when looking from above. This can be assembled whilst attached to the mast pole if desired.

### Radar Lantern Assembly

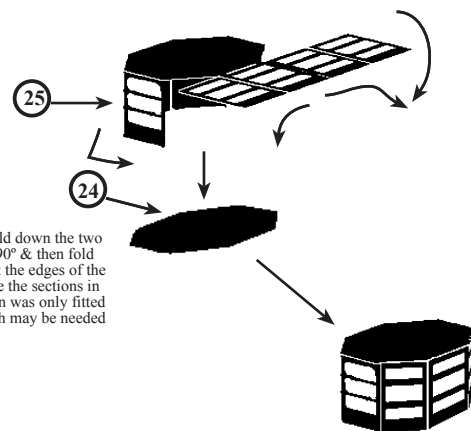

To assemble the 276 Lantern, fold down the two long sides on etched part 25, to 90° & then fold the octuple sections around to fit the edges of the top plate as shown above. Secure the sections in to place when shaped. The lantern was only fitted to some ships, so further research may be needed to establish which ones.

Sometimes the 276 radar antennas were fitted to the foremast platform without the lantern cover. The small 276 antenna is provided here for this case & is folded to shape as shown above.

### Wire Antenna Spreader

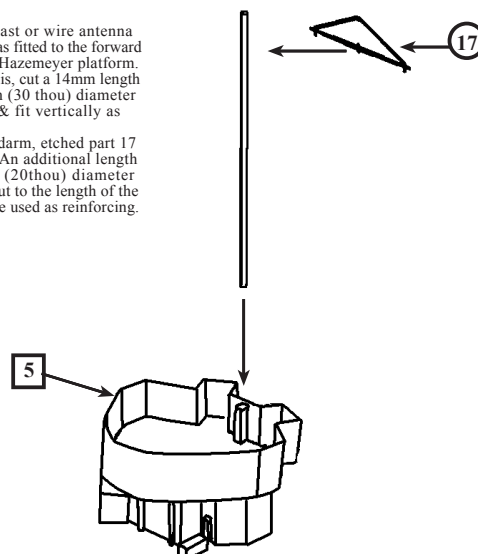

A small mast or wire antenna spreader was fitted to the forward end of the Hazemeyer platform. To make this, cut a 14mm length of 0.75mm (30 thou) diameter brass rod & fit vertically as shown.  
Fit the yardarm, etched part 17 as shown. An additional length of 0.5mm (20thou) diameter brass rod cut to the length of the spar may be used as reinforcing.

## Lattice Mast Assembly (Vigilant)

Fold the side lattices of etched part 15 around to 90° so that they are parallel, then bring the edges in together and secure in place. Fit the front lattice in place between the two front edges & secure in place.

Fold up the railings on the top platform, etched part 18, to 90° & fit the platform to the top of the mast. Fit the weather vane frame, etched part 20, to the underside of the platform. Fit the yardarms, etched parts 50, to the rear corners on the mast just below the top platform. Cut a top mast pole to the required height, (around 20mm) then fit the details required for the particular ship being modelled. The combination of parts varied from ship to ship, so research the ship being modelled to establish the correct antenna fit.

This radar was fitted to the top platform of the lattice mast. Assemble by folding the semi-circular plates back to 90° from the front plate. Cut a small length of plastic rod or stretched sprue & use as a spindle to fit the antenna to its base as shown above.

Fit the lattice mast to the top of the galley house as shown here. The yardarms may be reinforced with 20thou (0.5mm) brass rod if desired.

Make a top pole mast from .75mm (30thou) plastic or brass rod cut to the length of 20mm.

## Late Mainmast Variants

Shape the lattice mast, etched part 21, by folding each section to 90°, then bring the edges together & secure into place. The HF/DF antenna or the 291 antenna could be fitted to the top of this mast.

If the late war version is being modelled with the lattice foremast, the 291 radar antenna was moved aft & fitted on top of a mainmast pole. To make this pole cut a 34mm length of 0.1mm (40 thou) diameter brass rod & fit vertically from the forward end of the aft superstructure. Fit the 291 antenna as shown right along with a length of stock vertical ladder fitted to the side of the pole. Alternatively the HF/DF antenna could have been fitted on top of the pole mast instead.

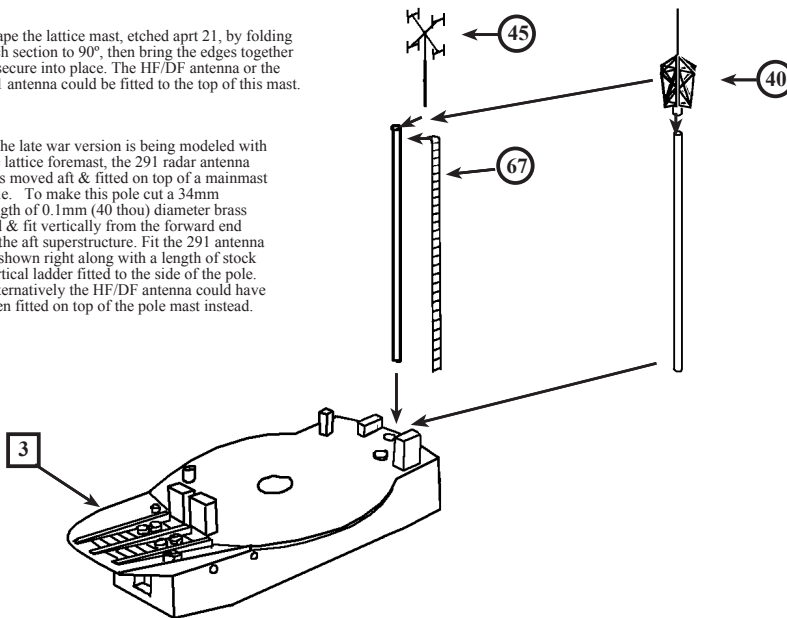

## Funnel Fittings

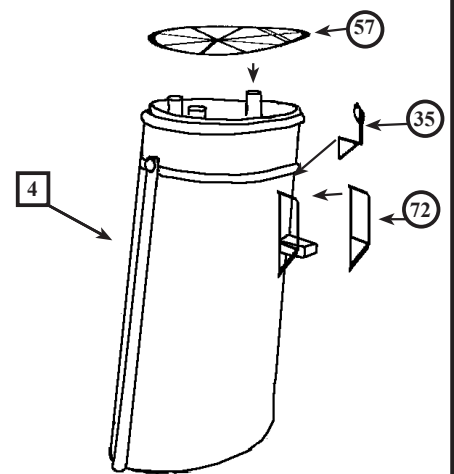

Fit funnel cap grille 57 as shown. Fold the handrails on the small platforms, etched parts 72 around so that they are parallel, with the square platform horizontal in between. A section of vertical ladder may also be fitted from the main deck to the platform. Fit siren bracket 35 to side of funnel above the platform.

## Boat Davit Assembly

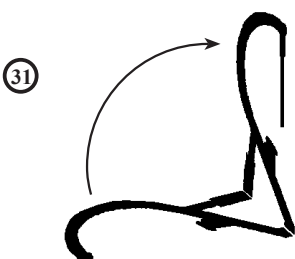

Fold the davits, etched parts 31, in half so that the relief-etched detail is outermost. Fix the halves together with adhesive.

## Ships Boats Assembly

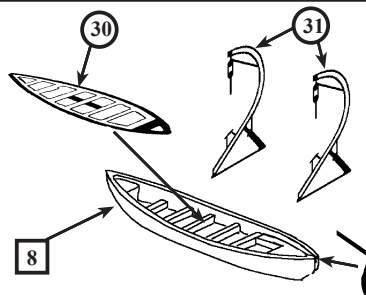

To fit the thwarts in to the whaler, first remove any remaining molded detail present inside the boat. Fit the thwarts as shown, then fit the rudder to the stern of the boat. It will be easier to fit the boats to the davits if the davits are first fitted into position on the main deck and secured in place.

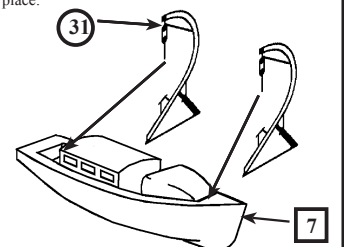

## Ship's Boats Location

Fit davits, etched parts 31, into position on the main deck & secure in place. Test fit the boats & note the position of where the falls will pass. Drill small holes through the boats at these positions & then pass the falls through the holes until the boats are snugly in position against the davits. Secure in place.

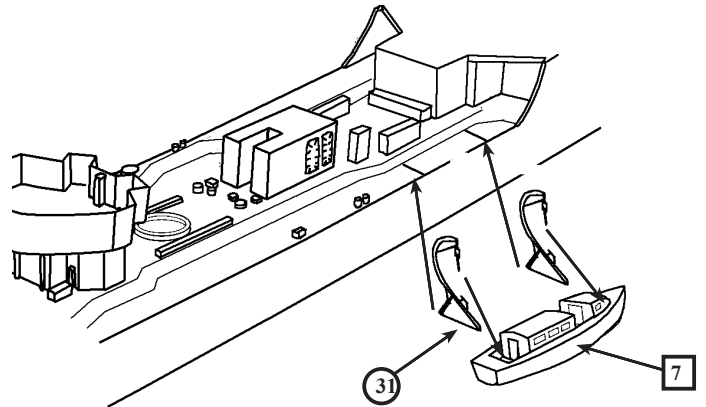
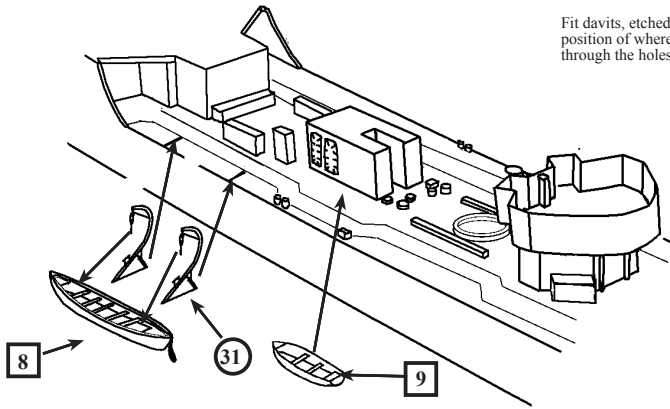

## Depth Charge Thrower Assembly

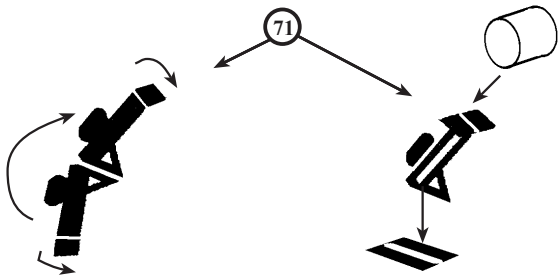

To assemble etched parts 71, fold the main body of the thrower gun in half so that it is double-thickness. Fold top plates outwards to 90° so that the depth charge can be located easily. Fit the base of the gun body to the footplate as shown above right. Make depth charges by cutting short lengths of 1.5mm (60 thou) diameter plastic rod & fit to the tops of the throwers. These may be used instead of the metal parts 23 if desired.

## Depth Charge Stowages

Fold the depth charge stowage frames to shapes shown below. Depth charges to fit into these stowages can be cut from 1.5mm (60 thou) diameter plastic rod. Or use some of the stock depth charges supplied with parts 22.

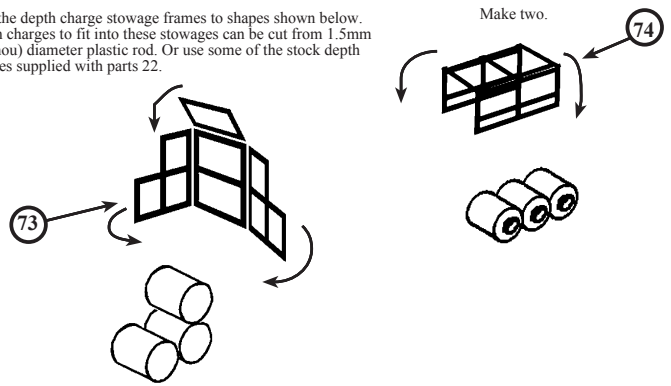

Make four.

## Depth Charge Stern Rails

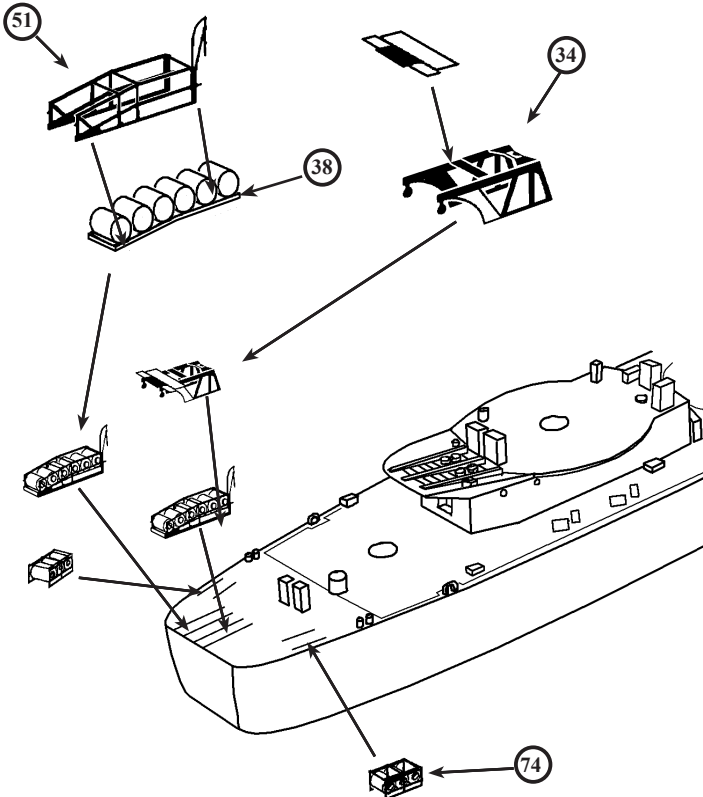

Assemble the depth charge rails, etched parts 51, by folding down the sides so that they are parallel. Fit in two lengths of depth charges supplied in the kit parts 22 to the rails as shown above. Fit the depth charge rails in position on the stern so that one set of rails is central. The second set of rails is set to port. Fold the TSDS gantry, etched part 34, to the shape shown, then fit the top plate in position. Fit the TSDS frame to the stern so that it straddles the centrally-positioned depth charge rails. Fit the small depth charge stowage racks, etched parts 74, to each side of the quarterdeck.

## Depth Charge Thrower Locations

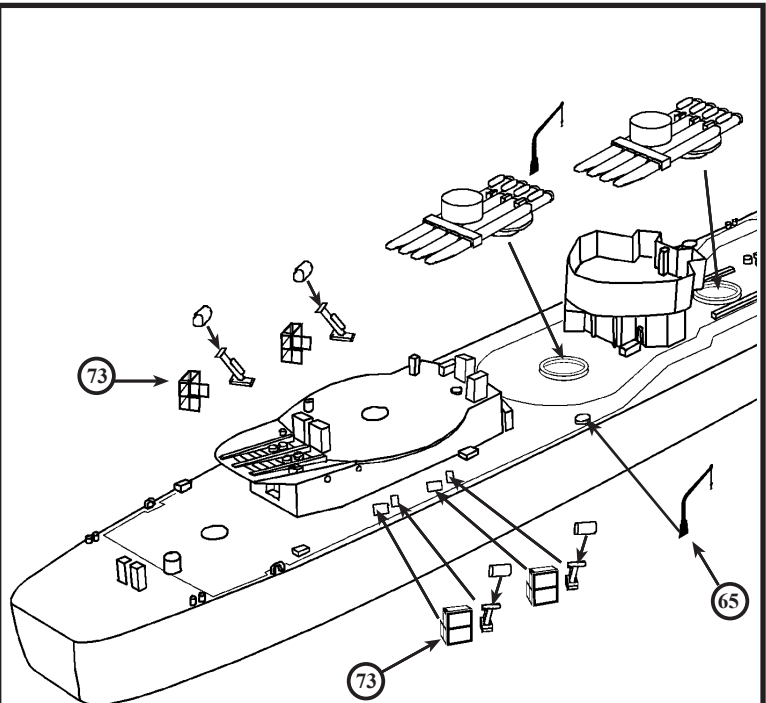

Fit the depth charge thrower assemblies to the positions shown on the main deck, abreast of the aft superstructure. Locate & secure the depth charge stowage racks, etched parts 73, to the positions shown on the deck beside the depth charge throwers.

Fit the bases of the torpedo loading davits to the raised positions on the main deck adjacent to the torpedo tube positions.

Fit the torpedo tubes supplied in the kit in to the positions shown above on the main deck.

## Foc'sle Fittings

Assemble the anchors, etched parts 33, by slotting the base through the rectangular hole in the tipping plate. Fit the anchors into the holes on each side of the bow. These may need to be drilled out further to take the shaft of the anchor.

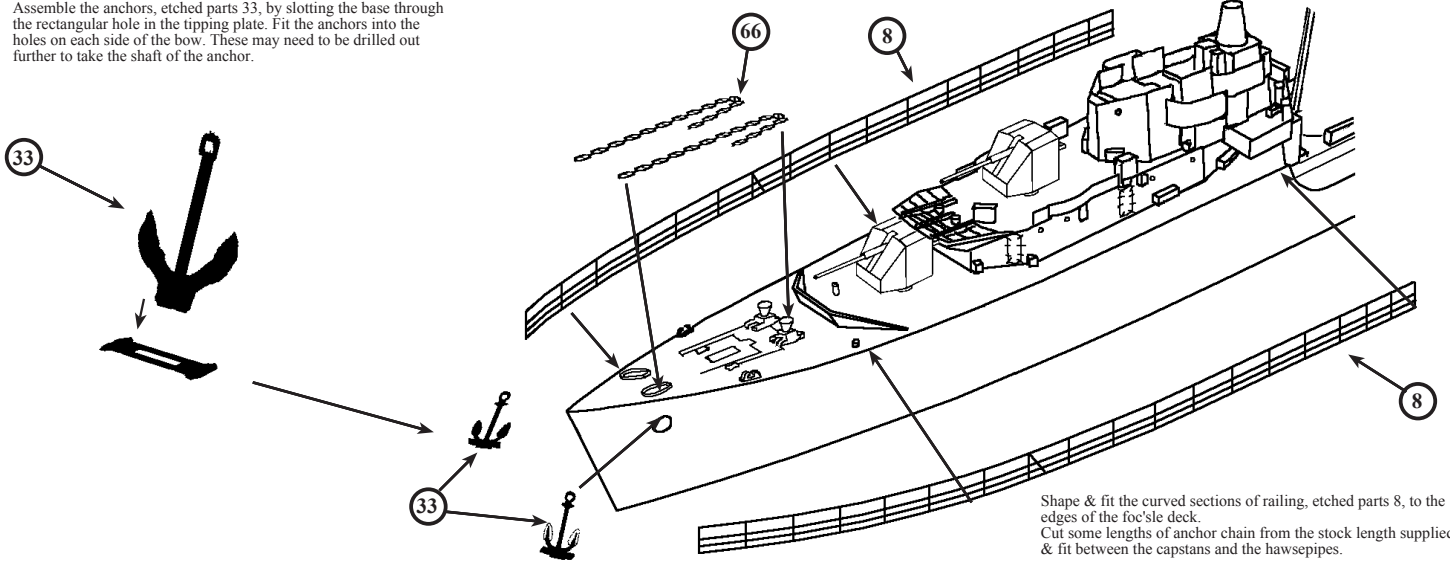

Shape & fit the curved sections of railing, etched parts 8, to the edges of the foc'sle deck.  
Cut some lengths of anchor chain from the stock length supplied & fit between the capstans and the hawsepipes.

## Torpedo Deck Catwalks

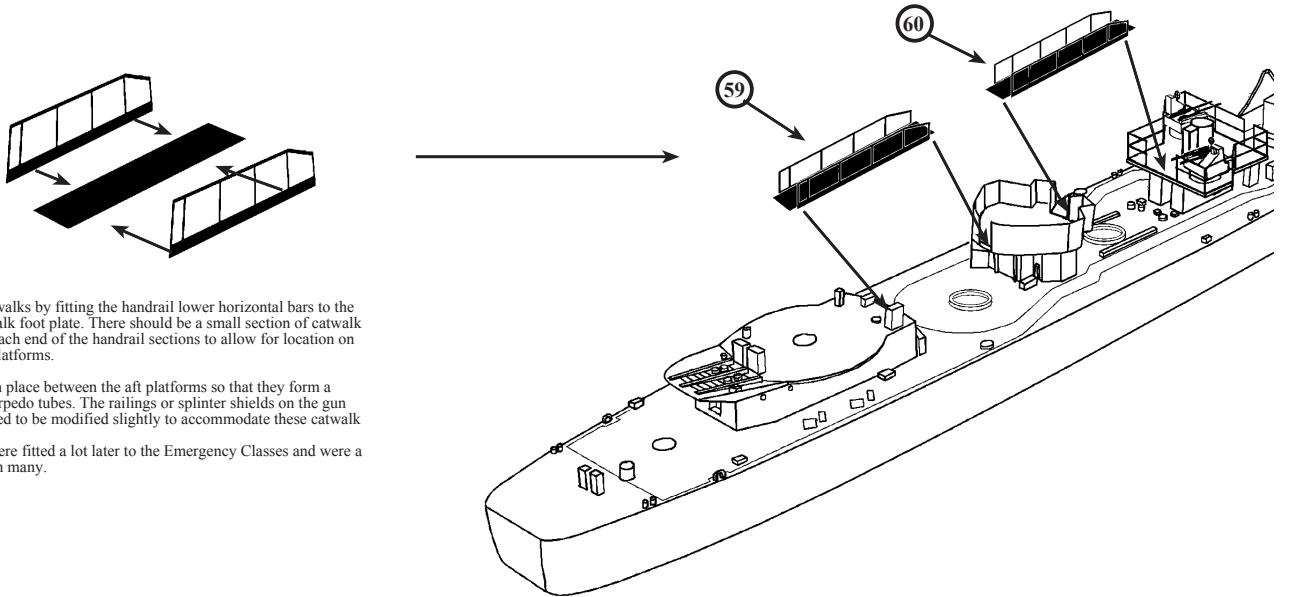

Assemble the catwalks by fitting the handrail lower horizontal bars to the edges of the catwalk foot plate. There should be a small section of catwalk protruding from each end of the handrail sections to allow for location on the edges of the platforms.

Fit the catwalks in place between the aft platforms so that they form a bridge over the torpedo tubes. The railings or splinter shields on the gun platforms may need to be modified slightly to accommodate these catwalk ends.  
These catwalks were fitted a lot later to the Emergency Classes and were a postwar feature on many.

## Propeller and Rudder Fitting

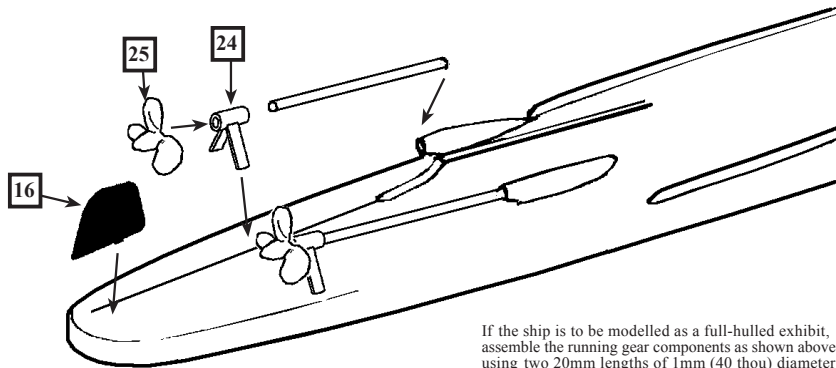

If the ship is to be modelled as a full-hulled exhibit, assemble the running gear components as shown above, using two 20mm lengths of 1mm (40 thou) diameter plastic rod.



COLOUR CHART AND PAINTING GUIDE

-  G10  
Colourcoats  
RN 23
-  B30  
Colourcoats  
RN 21
-  G45  
Colourcoats  
RN 14

-  Anti Fouling Red  
Colourcoats  
RN19

-  Deck Steel Grey  
Colourcoats  
RN 05

-  CEMTEX  
Humbrol 121  
(could be painted over)  
(in deck grey)

All colours quoted are from the Colourcoats range of authentic colours.

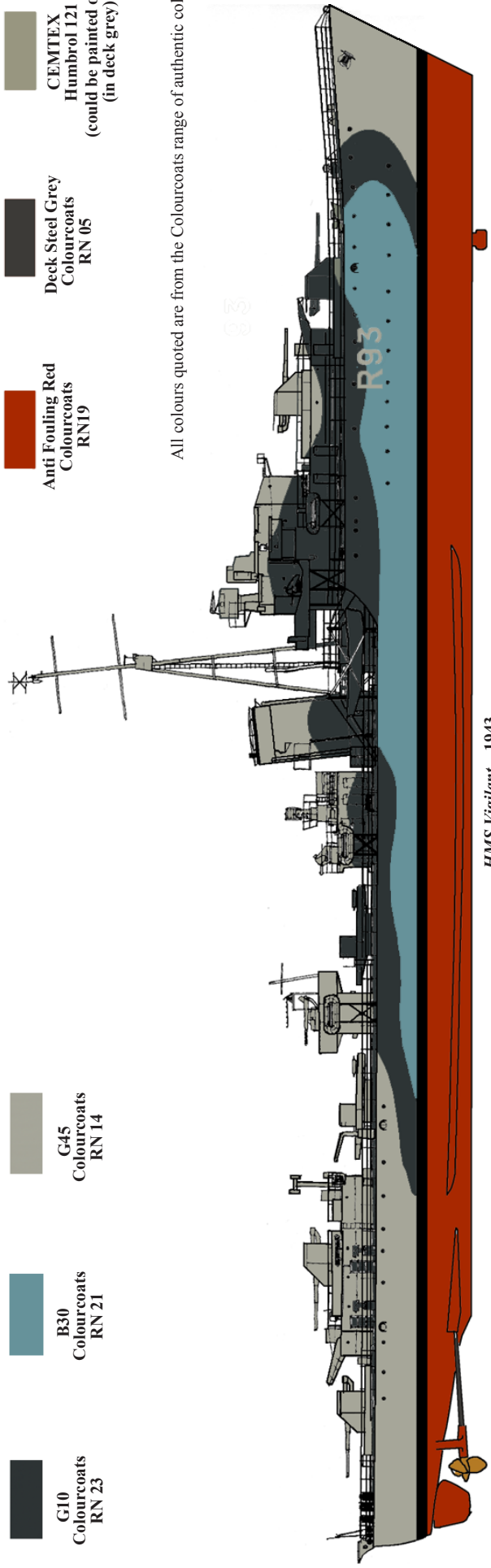

HMS Vigilant 1943

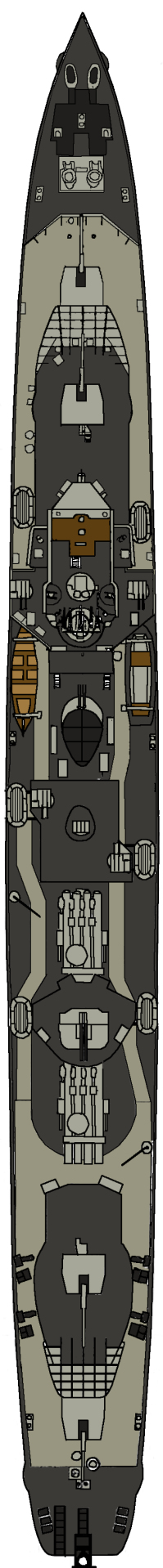

-  B20  
Colourcoats  
RN 16
-  G45  
Colourcoats  
RN 14

HMS Vigilant appeared in the scheme shown above through to the end of 1944 after she had been fitted with a lattice foremast.

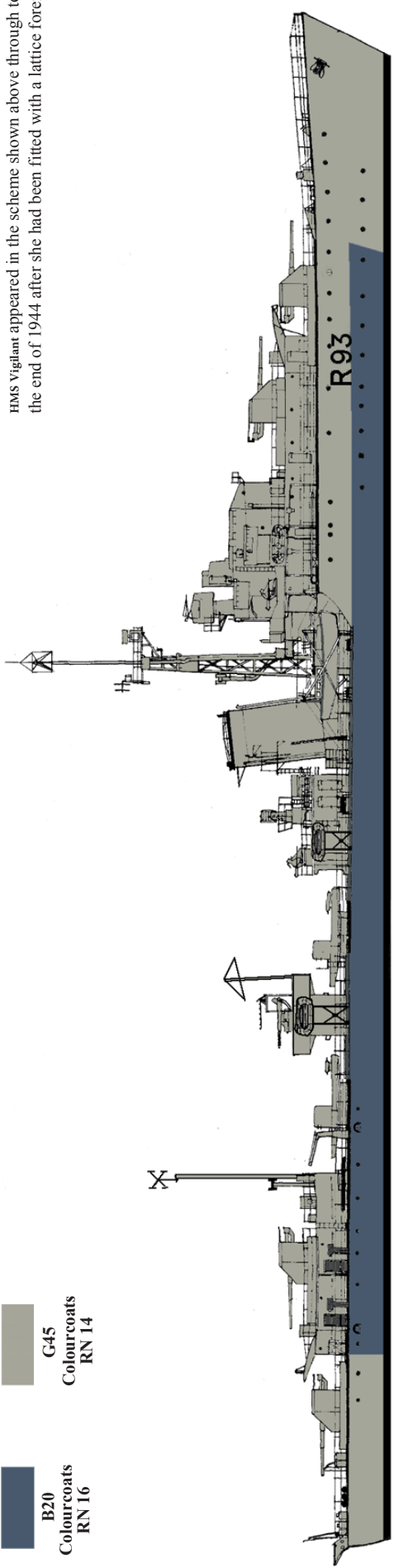

HMS Vigilant 1945