

**History**

HMS Tynedale was a Hunt Class Escort Destroyer of the first sub group (Type 1) and was laid down on 27th July 1939 at the yard of Alexander Stephen and Sons on the Clyde. She was launched 5th June 1940 and commissioned into the Royal Navy on 2nd December 1940. Tynedale was adopted by the Northumberland town of Hexham.

HMS Tynedale was initially based in Portsmouth as part of the 1st Destroyer Flotilla and was employed on convoy and escort duties for most of the time, until December 1941 when she was transferred to the 15th Flotilla based in Plymouth.

Her most notable action came when she was assigned to escort the Flotilla of ships and Coastal Craft on the mission to St Nazaire in Western France, in a raid using HMS Campbelltown, would destroy the large dry dock gates and prevent the large ships like Tirpitz from refitting there. Whilst at sea patrolling and waiting for the returning craft, she sighted the U-Boat U593 which she attacked and forced to the surface. A gun battle followed, but the submarine managed to dive again and escaped. After rendezvousing with the rest of the small craft, Tynedale and Atherstone were engaged by a flotilla of German E boats which they successfully fought off.

After returning to Plymouth, Tynedale was repaired and resumed her normal escort duties in the South Western Approaches. She was part of the task force that encountered and sank the German auxiliary cruiser Stier, and later in another incident the German auxiliary cruiser Komet.

In March 1943 HMS Tynedale was sent to the Mediterranean to join Destroyer Division 59 with duties to escort convoys running from Gibraltar to Algeria. She was an interceptor during the allied invasion of Sicily and assisted in rescuing survivors from a torpedoed Dutch freighter.

During convoy escorts on the 12th December 1943, HMS Tynedale was torpedoed by her old adversary U593 off the coast of Algeria. She broke in two and quickly sank with the loss of 73 lives. Ironically, the next day, U593 was depth charged and forced to surface where it was captured.

**Specifications**

Length: 279ft 10ins oa. Beam: 29ft Displacement: 1000 tons standard 1340 tons deep. Speed: 27 knots

Armament: 4 x 4 inch guns in two twin HA/LA mountings.

40 Depth Charges fired from 1 x Mk 1 depth charge rail and 2 x Mk 11 depth charge throwers.

1 x 4 barrelled 2 pounder Pom Pom. 2 x 20mm Oerlikons in 2 x Single Mountings

**Resin and Metal Parts Identification**

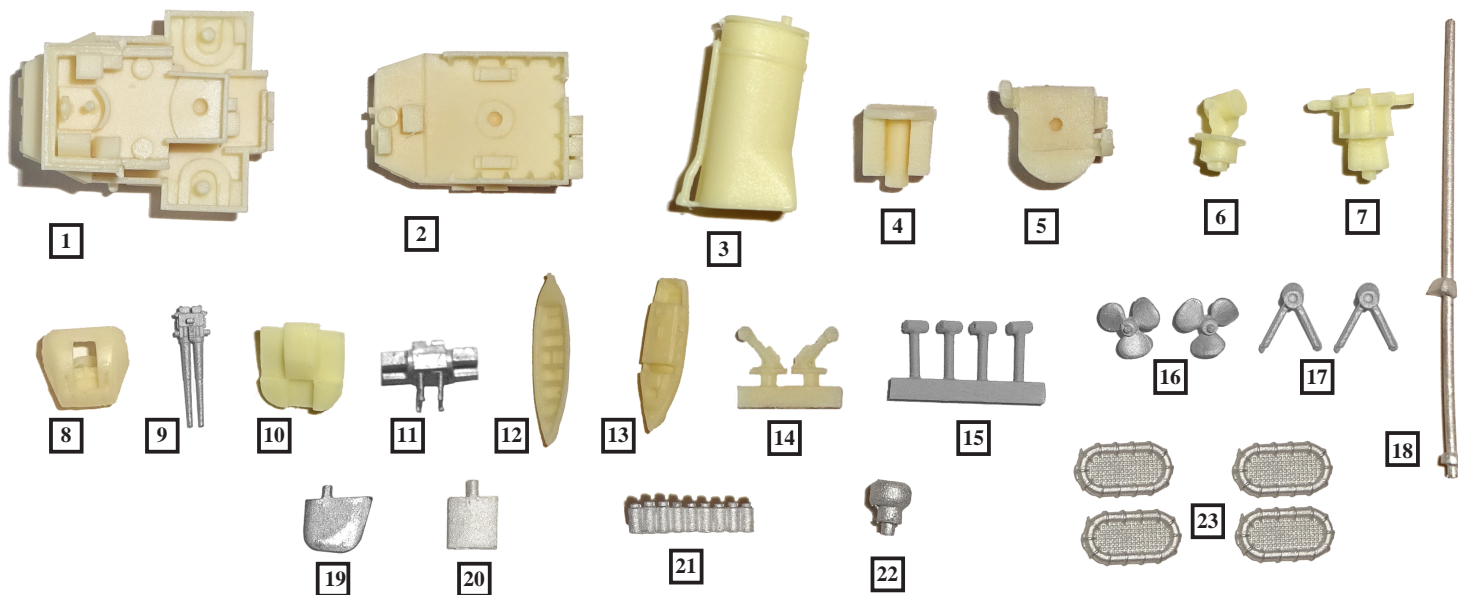

- |                              |                              |                           |                            |
|------------------------------|------------------------------|---------------------------|----------------------------|
| 1. Forward Superstructure    | 7. Rangefinder Director      | 13. 25' Adm Motor Cutter  | 19. Rudder                 |
| 2. Aft Superstructure        | 8. 4" Twin Gun Shield        | 14. Depth Charge Throwers | 20. Stabiliser Fins x 2    |
| 3. Funnel                    | 9. 4"/45 Twin Gun Mounting   | 15. Depth Charge Reloads  | 21. Depth Charge Rail Load |
| 4. Boiler Room Vent Platform | 10. 4 Barrelled Pom Pom Base | 16. Propellers            | 22. Asdic Dome             |
| 5. Searchlight Platform      | 11. 4 Barrelled Pom Pom      | 17. Propeller 'A' Frames  | 23. Carley Rafts           |
| 6. Searchlight Mounting      | 12. 27' Whaler Sea Boat      | 18. Fore Mast Pole        |                            |

This kit contains a mixture of resin and white metal small parts, of which some of the resin parts have been attached to sprues for ease of casting.

Care must be taken when detaching the parts from the sprues, to remove the flash without causing damage.

When cleaning off the excess material using files or abrasive paper, it is recommended that a mask is worn as resin dust can be harmful to health if inhaled.

# Photo Etched Parts Identification

ATLANTIC MODELS © 2023

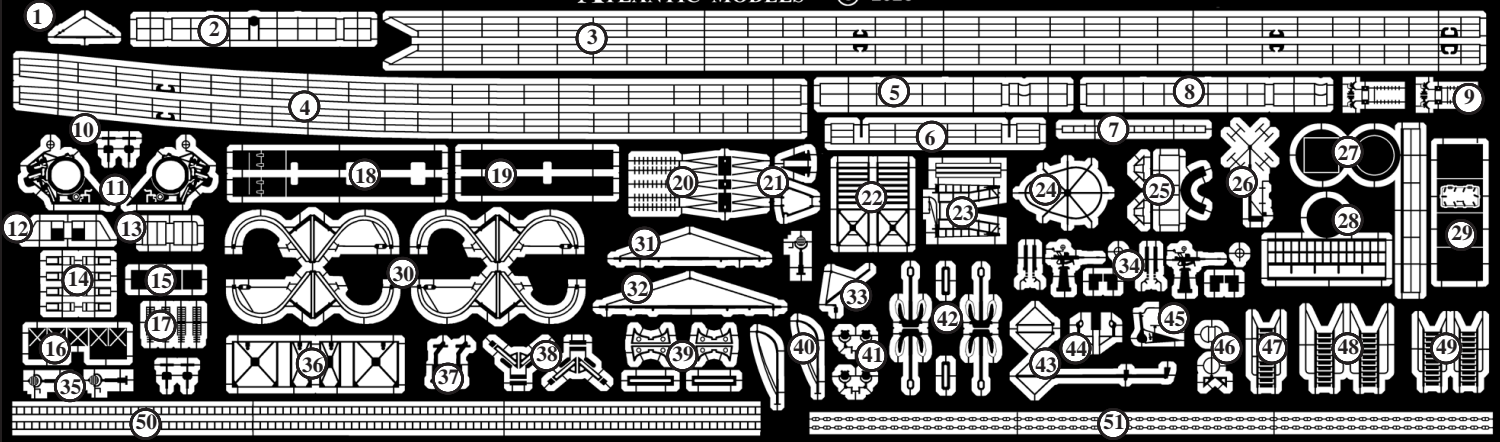

## HMS Tynedale 'Type 1 Hunt' Class Destroyer 1/350

- |                                    |                                 |                              |                                 |
|------------------------------------|---------------------------------|------------------------------|---------------------------------|
| 1. Main Mast Yardarm               | 14. Quad Pom Pom Ammo Box Sides | 27. 276 Radar Platform       | 40. Depth Charge Davits         |
| 2. Railings (Aft Superstructure)   | 15. Quad Pom Pom Front Shields  | 28. 276 Radar Lantern        | 41. Signal Lamps (Small)        |
| 3. Railings (Main Deck)            | 16. Quad Pom Pom Rear Shields   | 29. 276 Radar House          | 42. Anchors                     |
| 4. Railings (Fo'c'sle Deck)        | 17. Quad Pom Pom Ammo Belts     | 30. Boat Davits              | 43. MF/DF Antenna               |
| 5. Railings (Searchlight Platform) | 18. Splinter Shields Aft        | 31. Fore Mast Upper Yardarm  | 44. Funnel Sirens               |
| 6. Railings (Hull Step)            | 19. Splinter Shields Forward    | 32. Fore Mast Lower Yardarm  | 45. 25" Motor Cutter Parts      |
| 7. Bridge Windscreen               | 20. 285 Radar Yagi Antenna      | 33. Main Mast Gaff           | 46. Bridge Front DF Antenna     |
| 8. Railings (Boiler Room Vent)     | 21. 285 Radar Antenna Mounting  | 34. 20mm Oelikon Assembly    | 47. Inclined Ladder Signal Deck |
| 9. 282 Director Radar Antennas     | 22. Carley Raft Racks           | 35. Signal Lamps (Medium)    | 48. Inclined Ladders Bridge     |
| 10. 4" Gun Layers Seats            | 23. Depth Charge Rails          | 36. AA Gun Platform Supports | 49. Inclined Ladders Hull Step  |
| 11. Quad Pom Pom Mountings         | 24. Funnel Cap Grill            | 37. Range Finder Sights      | 50. Vertical Ladder Stock       |
| 12. Quad Pom Pom Rear Railings     | 25. Funnel Siren Platform       | 38. Depth Charge Throwers    | 51. Anchor Chain                |
| 13. Quad Pom Pom Front Railings    | 26. 291 Radar Antenna           | 39. 14' Dinghy Cradles       |                                 |

## Major Parts Location Diagram

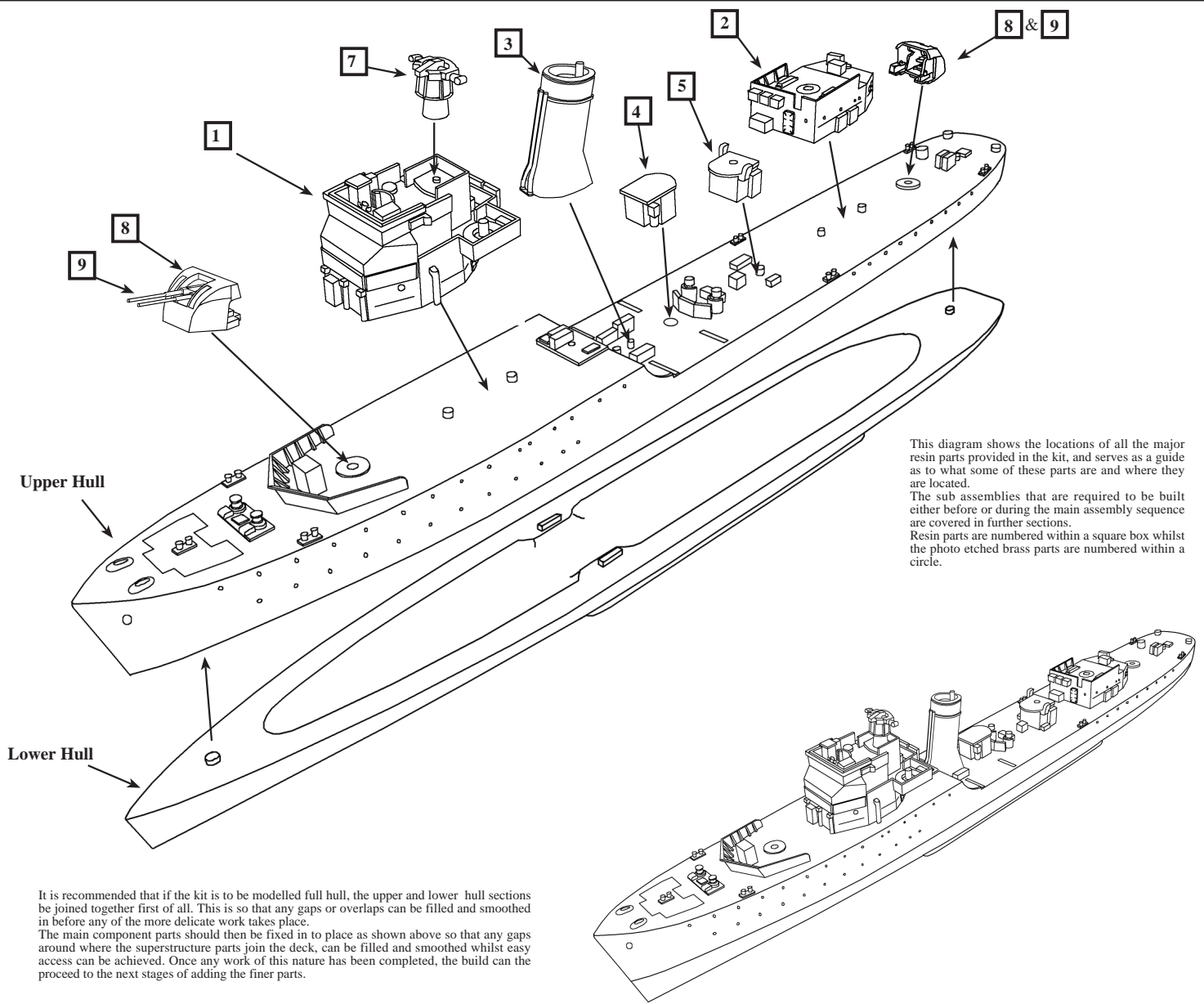

This diagram shows the locations of all the major resin parts provided in the kit, and serves as a guide as to what some of these parts are and where they are located. The sub assemblies that are required to be built either before or during the main assembly sequence are covered in further sections. Resin parts are numbered within a square box whilst the photo etched brass parts are numbered within a circle.

It is recommended that if the kit is to be modelled full hull, the upper and lower hull sections be joined together first of all. This is so that any gaps or overlaps can be filled and smoothed in before any of the more delicate work takes place. The main component parts should then be fixed in to place as shown above so that any gaps around where the superstructure parts join the deck, can be filled and smoothed whilst easy access can be achieved. Once any work of this nature has been completed, the build can proceed to the next stages of adding the finer parts.

### Twin 4" HA/LA Gun Mounting

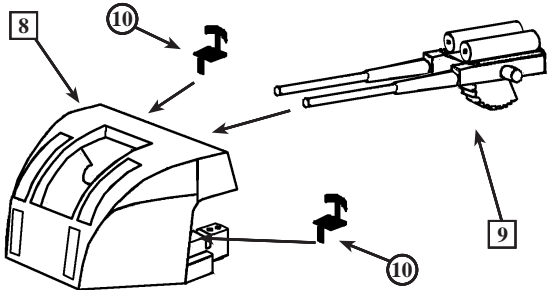

Fit the gun barrels metal parts 9, into the gun shield 8, so that the lugs on the sides of the gun fit into the recesses on the mounting inside the shield.  
Fold the gun layers seats, etched parts 10 to shape and fit to the forward ends of the fusing boxes.

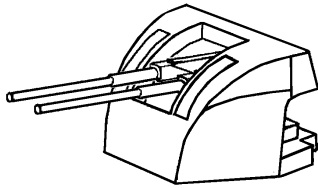

### 4 Barrelled Pom Pom Assembly

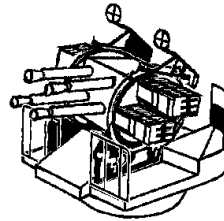
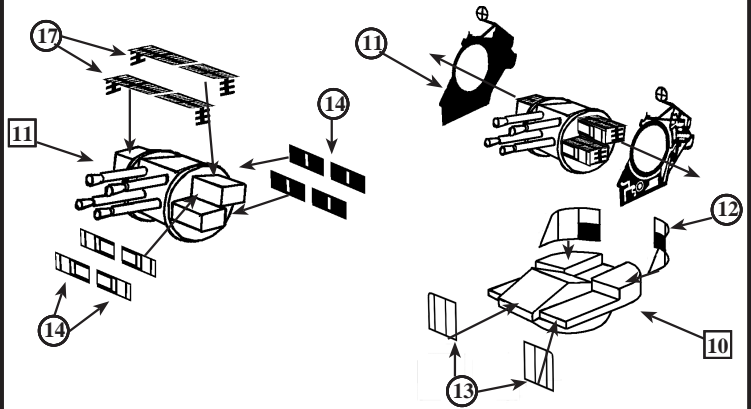

Clean any casting burrs off the metal parts 10 and 11.  
Fit the photo etched parts 11, mechanisms over the ammo boxes, so that the rings take up around the circular part of the barrel cluster.  
Secure the photo etched parts down either side of the angled centre of part 10. These will hold the barrel cluster in place, enabling it to elevate, if the glue has not made contact with the circular area.  
Fit Rear Handrails, etched parts 12, to the rear of the Pom Pom platform and the Front Rails, etched parts 13 as shown. These railings may be replaced with splinter shields, etched parts 15 and 16 if desired.  
Fit completed assembly to the aft superstructure deck.  
Further finer detail may be achieved by removing the soft white metal gun barrels and replacing them with turned brass gun barrels if desired.

### 20mm Oerlikon

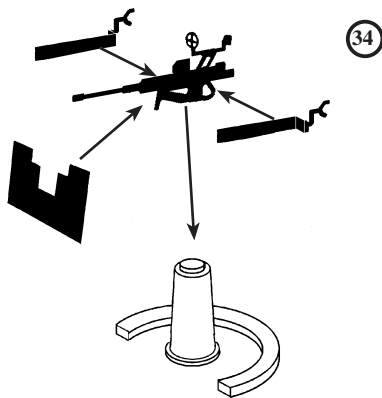

Assemble the 20mm Oerlikon mounting as shown above. The etched metal mounting pintles should be removed from the lower part of gun mounting before any assembly begins.  
Locate these into positions on the gun platforms on either side of the forward superstructure as shown in the section below.

### 285 Radar Yagi Antenna

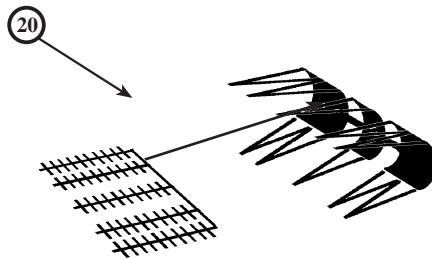

Assemble the 285 Fire Control antenna by folding a gentle curve on to the rectangular reflectors then folding over the stays so that they face forwards.  
Fit the set of dipoles centrally on to the reflector faces.  
Nip the pointed ends of the stays together so that they trap the centre bar of the dipoles between them.

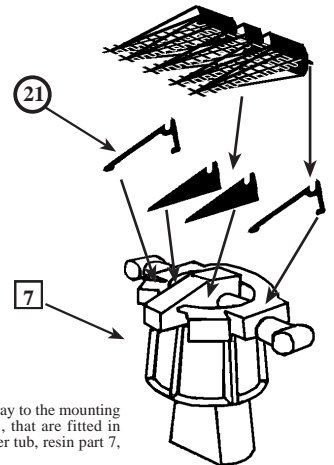

Fit the completed 285 Array to the mounting brackets, etched parts 21, that are fitted in position on the rangefinder tub, resin part 7, as shown above right.

### Forward Superstructure Fittings

Assemble the DF Antenna, etched part 16 and fit the half loops to each side of the central vertical pole on the antenna. This should appear as a cross when viewed from above

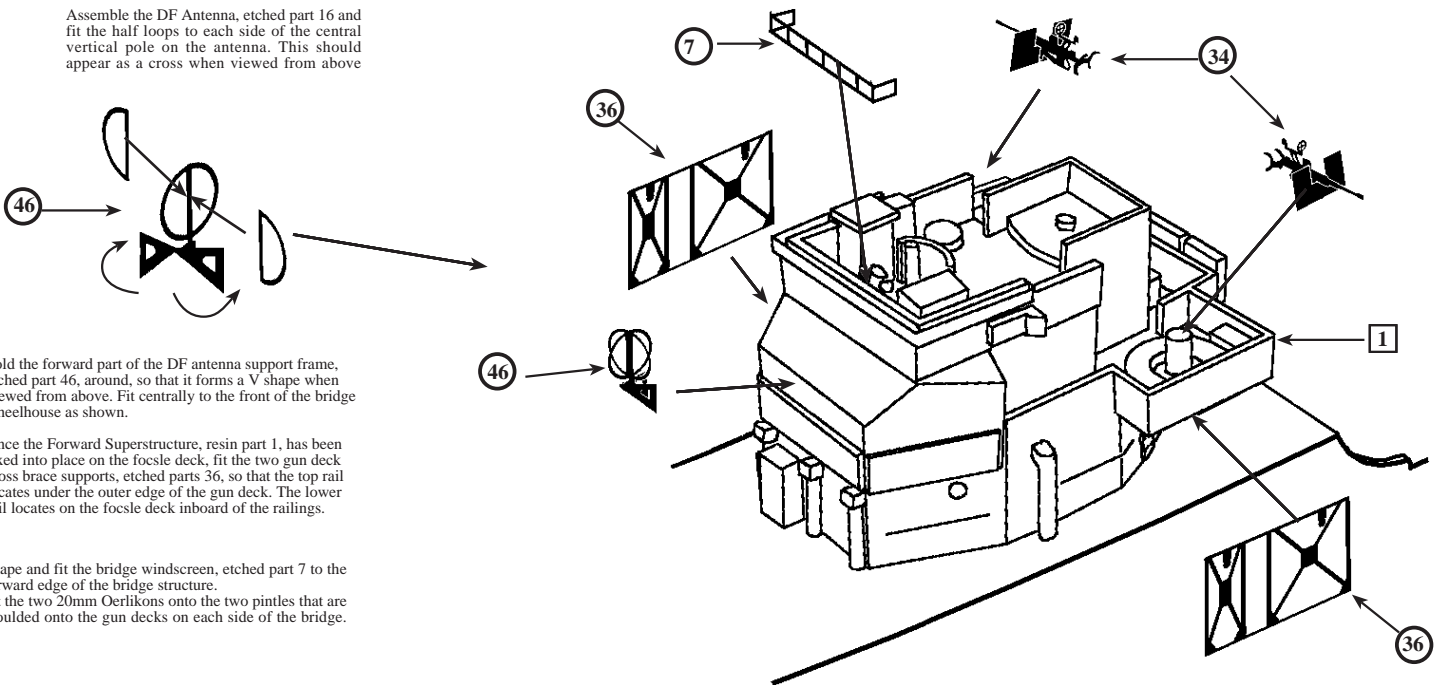

Fold the forward part of the DF antenna support frame, etched part 46, around, so that it forms a V shape when viewed from above. Fit centrally to the front of the bridge wheelhouse as shown.

Once the Forward Superstructure, resin part 1, has been fixed into place on the focsle deck, fit the two gun deck cross brace supports, etched parts 36, so that the top rail locates under the outer edge of the gun deck. The lower rail locates on the focsle deck inboard of the railings.

Shape and fit the bridge windscreen, etched part 7 to the forward edge of the bridge structure.  
Fit the two 20mm Oerlikons onto the two pintles that are moulded onto the gun decks on each side of the bridge.

## 291 Radar Antenna and Fore Mast Assembly

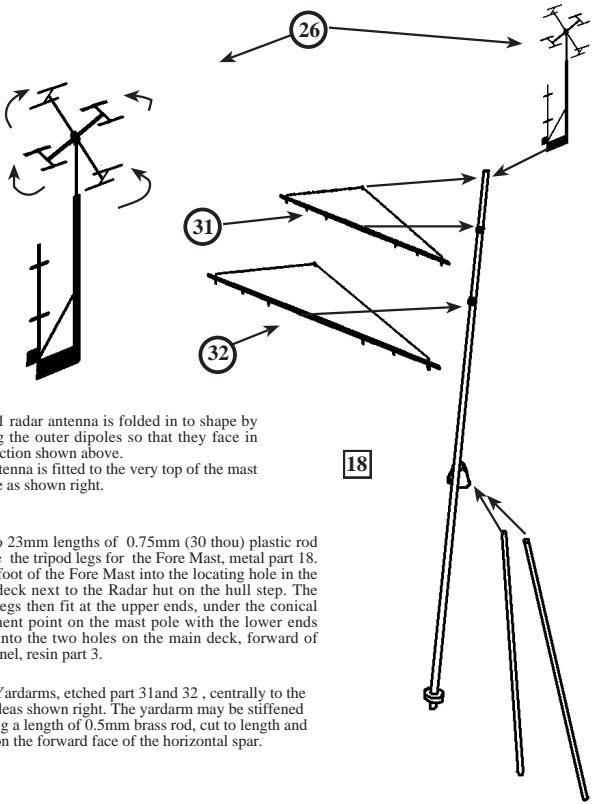

The 291 radar antenna is folded in to shape by bending the outer dipoles so that they face in the direction shown above. This antenna is fitted to the very top of the mast pole as shown right.

Cut two 23mm lengths of 0.75mm (30 thou) plastic rod to make the tripod legs for the Fore Mast, metal part 18. Fit the foot of the Fore Mast into the locating hole in the focsle deck next to the Radar hut on the hull step. The tripod legs then fit at the upper ends, under the conical attachment point on the mast pole with the lower ends fitting into the two holes on the main deck, forward of the Funnel, resin part 3.

Fit the Yardarms, etched part 31 and 32, centrally to the mast poles shown right. The yardarm may be stiffened by gluing a length of 0.5mm brass rod, cut to length and placed on the forward face of the horizontal spar.

## HF/DF Antenna and Main Mast Assembly

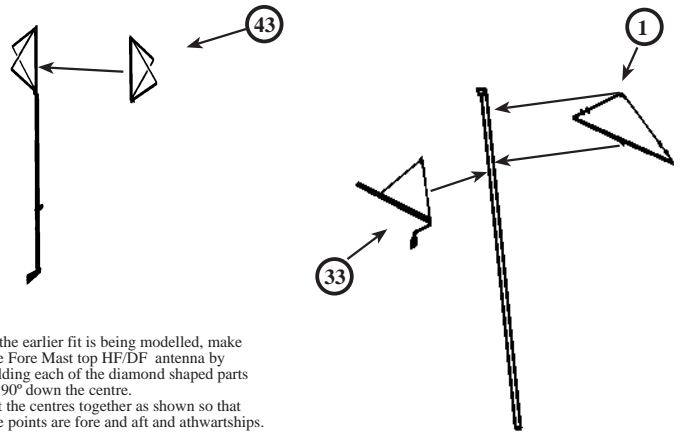

If the earlier fit is being modelled, make the Fore Mast top HF/DF antenna by folding each of the diamond shaped parts to 90° down the centre. Fit the centres together as shown so that the points are fore and aft and athwartships.

To make a Main Mast pole, cut a 27mm length of 0.5mm diameter brass rod and fit the etched parts 1 and 33 as shown above. The horizontal spar of etched part 1 may be stiffened by adding a length of 0.5 mm brass rod to the forward face of the spar.

## Depth Charge Thrower Assembly

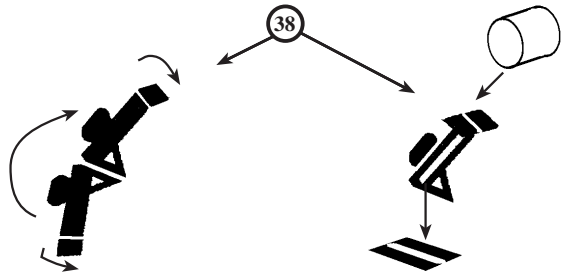

To assemble etched parts 38, fold the main body of the thrower gun in half, so that it is double thickness. Fold top plates outwards to 90° so that the depth charge can be located easily. Fit the base of the gun body to the footplate as shown above right. Make depth charges by cutting short lengths of 1.5mm (60thou) diameter plastic rod and fitting to the tops of the throwers. These may be used instead of the resin parts 14 if desired.

## Funnel Fittings

Fold down the short legs around the outside of the funnel cap grill, etched part 24, as shown right so that they locate onto the rim of the funnel cap. Fit the two siren horns, etched parts 44, to a position just above the line of the siren platform location.

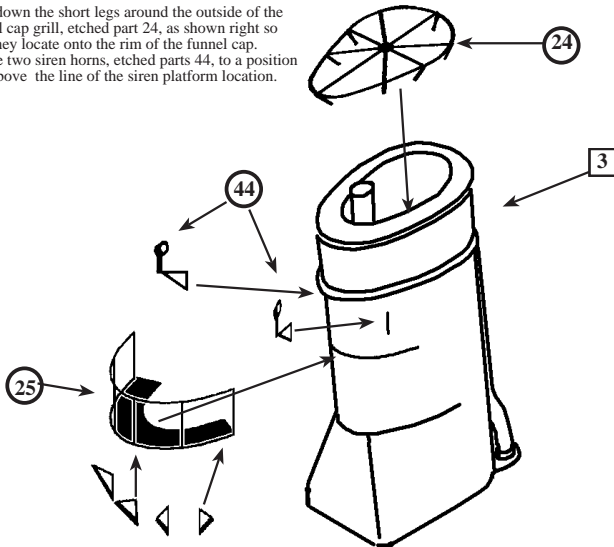

Fold up the railing on the funnel Siren Platform, etched part 25, to 90° and shape to fit around the outer edge of the platform. Fit the triangular support brackets to the underside of the platform. One at each end and the other two at equal distances in between. Fit the siren platform to the rear of the funnel as shown above. A length of vertical ladder can be fitted between the centre of the siren platform and the AA platform below.

## Depth Charge Rails

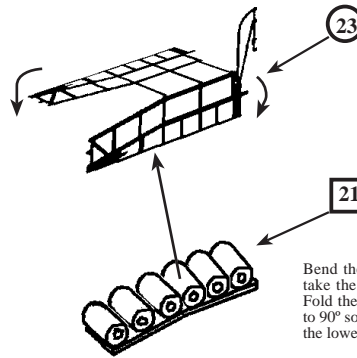

Bend the first three depth charges down to a slight angle to take the shape of the lower rail on the etched rail frame 23. Fold the side of the depth charge rail frames, etched parts 23, to 90° so that they are parallel. Fit the depth charges in between the lower rails of the frame.

## 276 Radar Lantern (Alternative Ships of the Class)

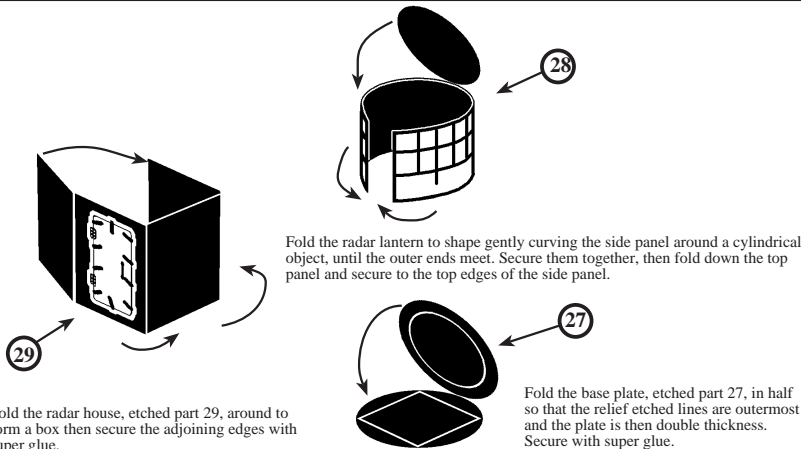

Fold the radar lantern to shape gently curving the side panel around a cylindrical object, until the outer ends meet. Secure them together, then fold down the top panel and secure to the top edges of the side panel.

Fold the base plate, etched part 27, in half so that the relief etched lines are outermost and the plate is then double thickness. Secure with super glue.

Fold the radar house, etched part 29, around to form a box then secure the adjoining edges with super glue.

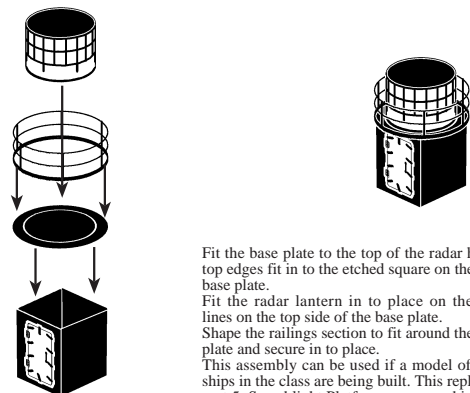

Fit the base plate to the top of the radar house, so that the top edges fit in to the etched square on the underside of the base plate.

Fit the radar lantern in to place on the circular etched lines on the top side of the base plate. Shape the railings section to fit around the edge of the base plate and secure in to place.

This assembly can be used if a model of any of the other ships in the class are being built. This replaces the resin part 5, Searchlight Platform on some ships and is fitted on top of it on some others. Further research will be required.

## Boats Location and Depth Charge Throwers

Fold the davits, etched parts 30 in half so that the relief etched detail is outermost. Fix the halves together with adhesive.

Fit davits, etched parts 30, in to position on the main deck and secure in to place. Test fit the boats and note the position of where the falls will pass. Drill small holes through the boats at these positions and then pass the falls through the holes until the boats are snugly in position against the davits. Secure in to place.

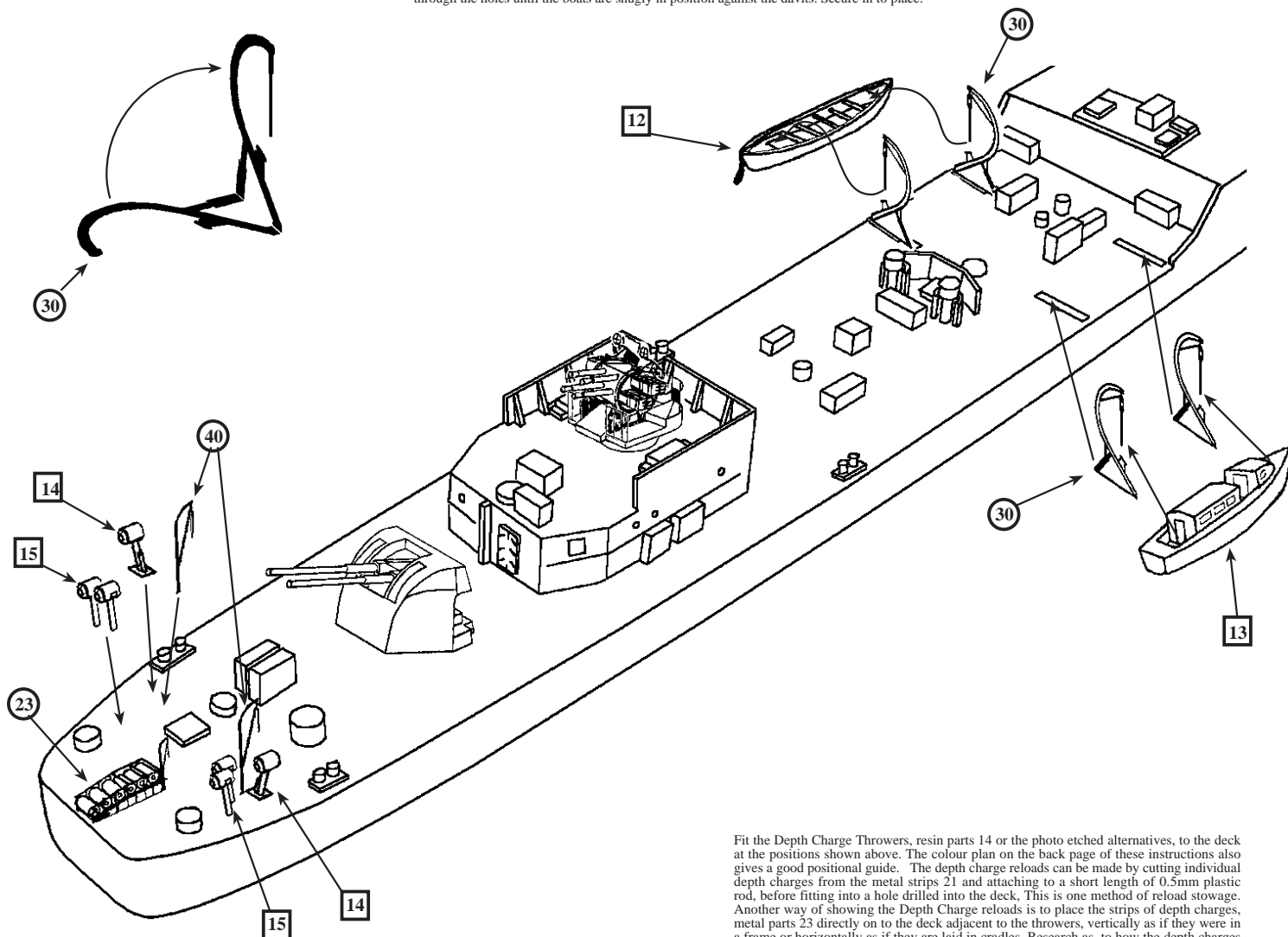

Fit the Depth Charge Throwers, resin parts 14 or the photo etched alternatives, to the deck at the positions shown above. The colour plan on the back page of these instructions also gives a good positional guide. The depth charge reloads can be made by cutting individual depth charges from the metal strips 21 and attaching to a short length of 0.5mm plastic rod, before fitting into a hole drilled into the deck. This is one method of reload stowage. Another way of showing the Depth Charge reloads is to place the strips of depth charges, metal parts 23 directly on to the deck adjacent to the throwers, vertically as if they were in a frame or horizontally as if they are laid in cradles. Research as to how the depth charges were stowed on various ships is recommended.

### Aft Superstructure Fittings and Searchlight Platform

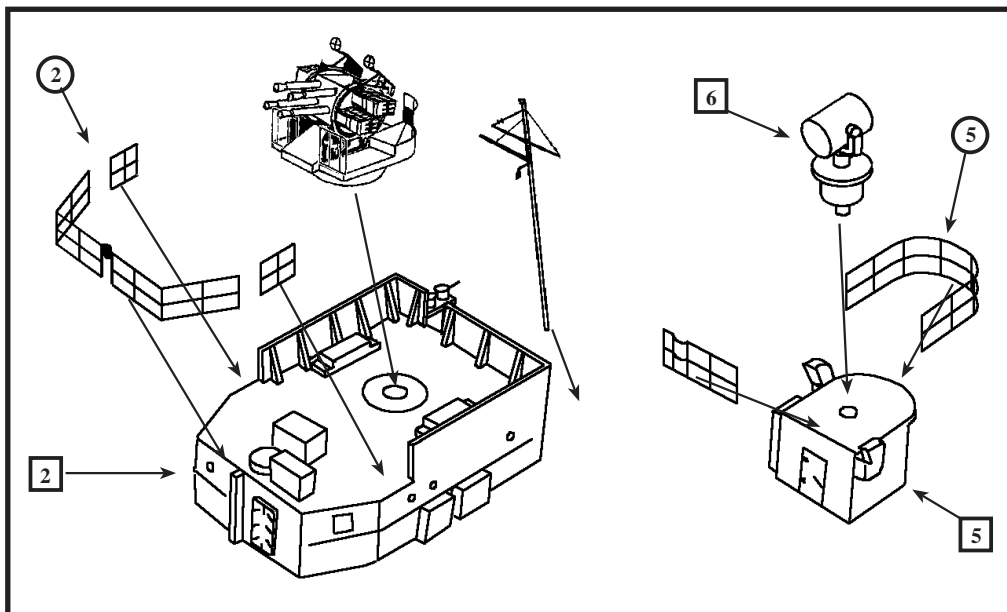

Once the aft superstructure, resin part 5 has been securely fitted to the main deck aft, fit the Quad Pom Pom assembly as shown in X position. Fit the main mast pole assembly centrally to the main deck 5mm forward of the aft superstructure as shown above left. Shape and fit the railings sections, etched parts 2, to the aft edges of the deck as shown above.

Shape the railing section, etched part 5, to fit around the edge of the Searchlight Platform, resin part 5, as shown above. Fit the Searchlight, resin part 6, to the locating hole in the deck of the platform.

### Anchor Assembly

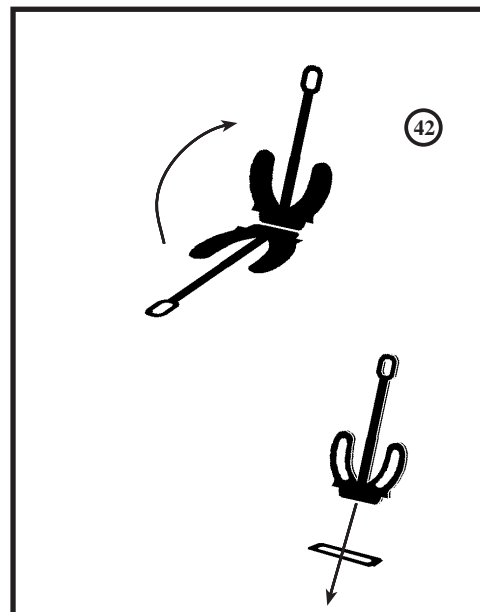

Assemble photo etched anchors 42 as shown above. Fit anchors into the hawse pipes each side of the bow, after first drilling out the holes with a 1.3mm drill bit.

## Railings and Carley Raft Rack Location

Shape and fit the railing sections, etched parts 4, to the edges of the focsle deck as shown below. Fit the railing section, etched part 6, to the edge of the hull step as shown right.

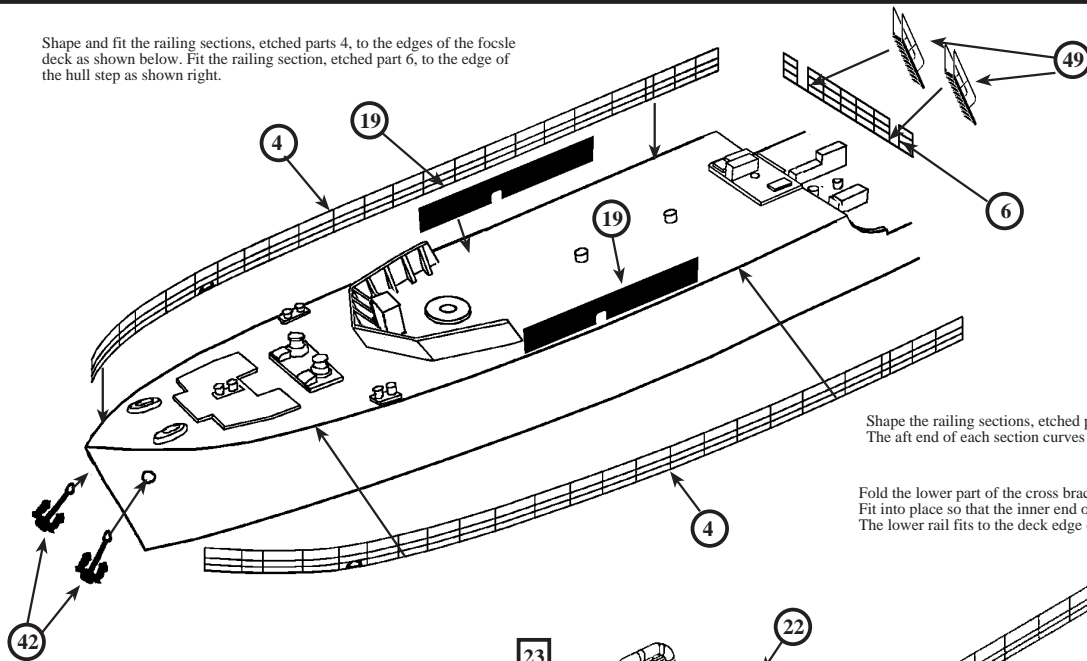

Shape the inclined ladders, etched parts 49, by folding the handrails up to 90° so that they are parallel. Turn each step individually so that they are horizontal. Fit in place to the hull step as shown left.

Shape the railing sections, etched parts 3, to fit the edges of the main deck aft of the hull step. The aft end of each section curves around the stern and stops at the Depth Charge rails.

Fold the lower part of the cross braced Carley Raft racks, etched parts 22, down to approx 80°. Fit into place so that the inner end of each rack fits against the side of the aft superstructure. The lower rail fits to the deck edge outboard of the railings.

Fit the anchors, etched parts 42, into place on the bow by first drilling out the HawsePipe holes with a 1mm drill bit. Allow enough depth so that the shank of the anchor can mostly fit inside. Trim as necessary.

Fit the Carley Rafts, metal parts 23, to the outsides of the racks as on some ships, or they can be fitted on top of the racks as on others. The choice depends on research into the particular ship being modelled.

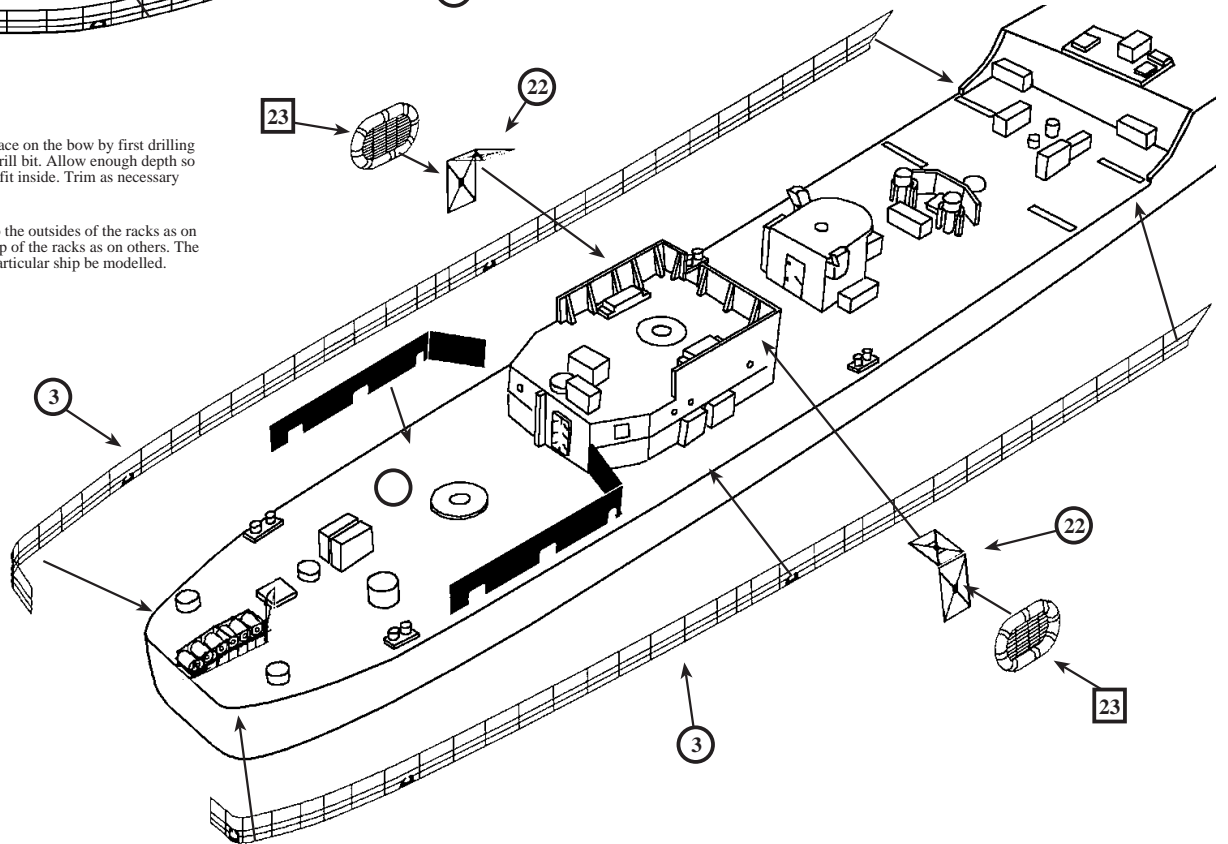

## Propeller and Rudder Fittings

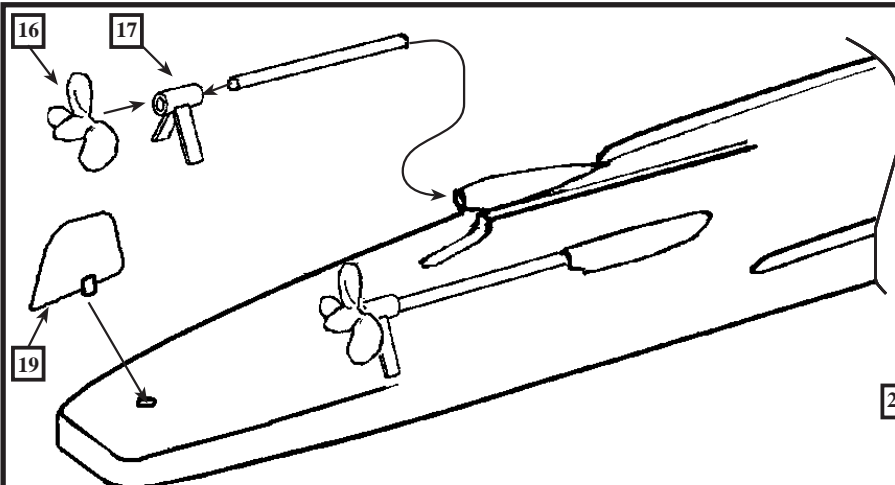

Fit the propellers to the outer side of the bearing A Frames as shown left. The legs of the A frames can be trimmed so that they fit in alignment with the stern gland openings on each side, with the shafts cut to length and fitted in to place.

Fit the stabiliser fins, metal parts 20 to the locating holes on each side of the Lower Hull forward of the bilge keels.

The Asdic Dome, metal part 22, can be fitted as an option as this item was retractable into the underside of the hull.

If the ship is to be modelled as a full hulled exhibit, assemble the running gear components as shown above, using two 20mm lengths of 0.75mm (30thou) diameter brass or plastic rod.

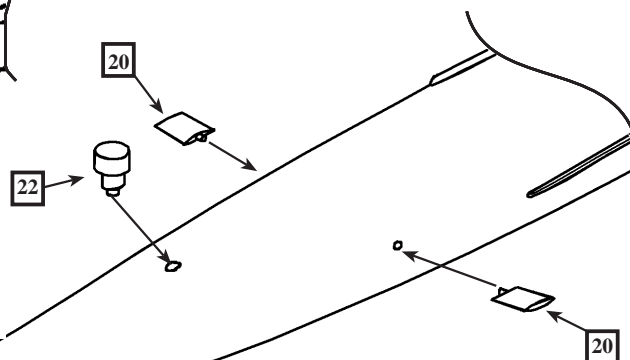

## Colour Chart and Painting Guide

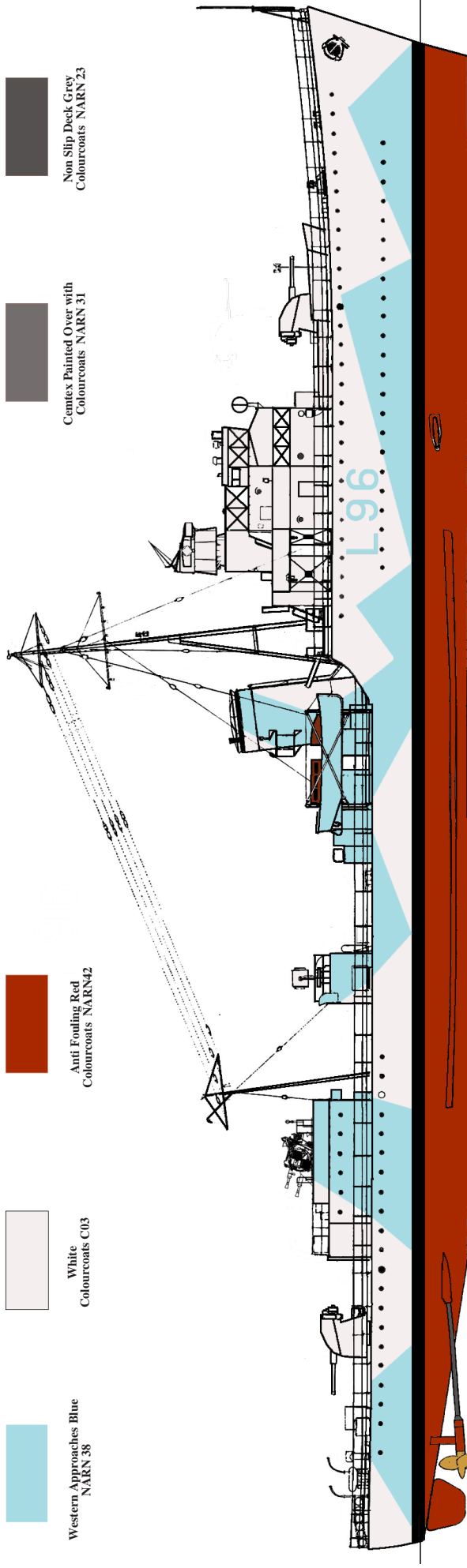

Western Approaches Blue  
NARN 38

White  
Colourcoats C03

Anti Fouling Red  
Colourcoats NARN42

Context Painted Over with  
Colourcoats NARN 31

Non Slip Deck Grey  
Colourcoats NARN 23

HMS Tynedale 1942

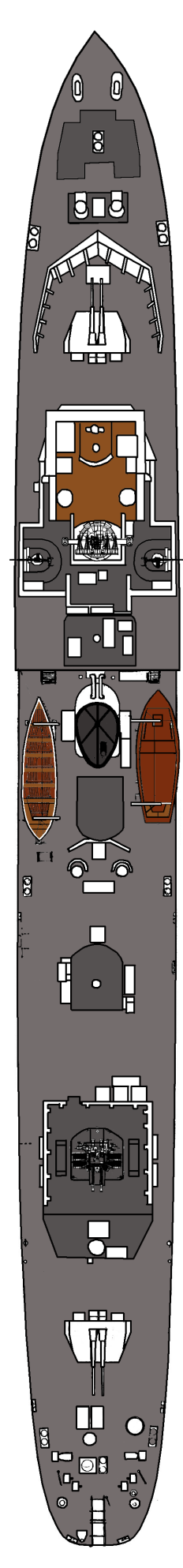

The colour guide has given the references for Colourcoats Enamel Paints that are available from Sovereign Hobbies.com but it is clear that these are readily available or accessible in some areas, nor are they available in Acrylic. Therefore an alternative set of Humbrol reference numbers has been listed below with the nearest alternative colour match.

- Non Slip Deck Grey = Humbrol 27
- Western Approaches Blue = Humbrol 65
- White = Humbrol 34
- Anti Fouling Red = Humbrol 100
- Grey Painted Context = Humbrol 106

**Other Colours:**

- Black
- Bronze
- Natural Wood

- Funnel Cap, Gun Barrels on Pom Poms, Waterline Boot Topping
- Propellers and Ammunition in trays on Pom Poms.
- Inner Decks and Thwarts on Ships Boats, Bridge Platform, Carley Raft Gratings